

## Compressed-air hoses

10A



PE (Polyethylene), PA (Polyamide), PU (Polyurethane),  
Flamex PTFE (Polytetrafluorethylene),  
FEP (Fluorethylenpropylene), PVC reinforced,  
PVC with fabric lining, NBR (Perbunan) with metal  
braiding

## Eisele compressed-air hoses

Eisele stocks a large assortment of compressed-air hoses, in order to be able to offer the correct quality, dimension and color for each application.

The following table shows which connection systems can be assigned to the respective hose quality.

### Allocation of connection systems and compressed-air hoses

Connection system	Compressed-air hose							
	PE	PA	PU	Flamex	PTFE/FEP	PVC reinforced	PVC with fabric lining	NBR with metal braiding
<b>10</b>	•	•	•		•	•	•	•
<b>12</b>	•	•	•					
<b>14</b>	•	•	•	•				
<b>14A</b>	•	•	•	•	•			
<b>15</b>	•	•	•	•				
<b>15A</b>	•	•	•	•	•			
<b>17</b>	•	•	•	•	•			
<b>18</b>			•					

Further data can be taken from the tables for the individual hose qualities.

## Compressed-air hose

- Polyethylene (PE)
- Color natural (red, blue, green, yellow, black and gray: indicate when ordering; additional price 10%)
- Suitable for screw-joints and plug connectors of the programs 10, 12, 14, 14A, 15, 15A and 17
- Temperature range -10° up to +40 °C

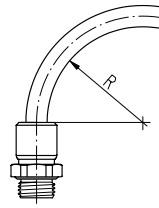

10A

Part no.	Outside $\varnothing$ / Inside $\varnothing$	max. permissible pressure	min. permissible bending radius R	g / m
04-0402	4 / 2	8 bar	15	9.3
04-4303	4.3 / 3	8 bar	15	7.0
04-0503	5 / 3	8 bar	20	11.5
04-0604	6 / 4	8 bar	30	14.0
04-0806	8 / 6	7 bar	45	19.7
04-1008	10 / 8	6 bar	60	27.8

## Compressed-air hose

- Polyamide (PA)
- Color natural (red, blue, green, yellow, black and gray: indicate when ordering; additional price 10%)
- Suitable for screw-joints and plug connectors of the programs 10, 12, 14, 14A, 15, 15A and 17
- Temperature range -20° up to +80 °C
- Suitable for vacuum

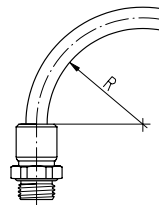

Part no.	Outside $\varnothing$ / Inside $\varnothing$	max. permissible pressure	min. permissible bending radius R	g / m
05-0402	4 / 2	15 bar	25	9.5
05-4303	4.3 / 3	15 bar	25	7.9
05-0503	5 / 3	15 bar	30	12.5
05-0604	6 / 4	15 bar	40	16.4
05-0806	8 / 6	12 bar	55	22.0
05-1008	10 / 8	12 bar	75	29.9

## Compressed-air hose

- Polyurethane (PU)
- Color black (red, blue, green, yellow, natural and gray: indicate when ordering; additional price 10%)
- Suitable for screw-joints and plug connectors of the programs 10, 12, 14, 14A, 15, 15A, 17 and hose nozzles of the pages 226 and 229 and of the program 18
- Temperature range -35° up to +60 °C
- Suitable for vacuum

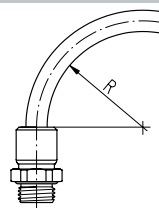

Part no.	Outside $\varnothing$ / Inside $\varnothing$	max. permissible pressure	min. permissible bending radius R	g / m
03-0402	4 / 2.3	8 bar	15	10.3
03-4303	4.3 / 3	7 bar	15	9.9
03-0503	5 / 3	8 bar	20	14.8
03-0604	6 / 4	8 bar	30	19.6
03-0806	8 / 6	7 bar	45	30.3
03-1008	10 / 8	5 bar	60	42.8
03-1209	12 / 9	7 bar	75	59.6
03-1411	14 / 11	6.5 bar	80	71.0

### Notice

Eisele compressed-air hoses are supplied exclusively on reels of 50 m.

**Flamex hose**

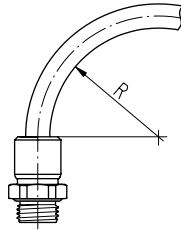

- Special hose flame-resistant material, resistant to weld spatter and flying sparks
- Polyurethane (PUR)
- Color black
- Classification to UL94 V2 to V0
- UV resistant
- Suitable for plug connectors of the programs 14 <sup>1)</sup>, 14A, 15, 15A and 17
- Temperature range -35 ° up to +100 °C
- Suitable for vacuum

Part no.	Outside ø / Inside ø	max. permissible pressure	min. permissible bending radius R	g / m
114-0402	4 / 2	20 bar	15	12.0
114-0804	8 / 4	20 bar	15	47.9
114-1006	10 / 6	20 bar	20	63.8
114-1208	12 / 8	20 bar	40	79.8
114-1410	14 / 10	20 bar	50	95.8

<sup>1)</sup> Plug connectors of the program 14 are particularly suitable for the use of Flamex hoses, because the release sleeve additionally protects against weld spatters. Therefore they are also still easily unlockable if they have been exposed to weld spatters over a longer time.

**Compressed-air hose**

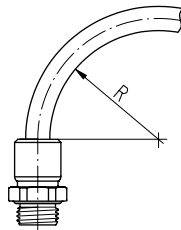

- Polytetrafluorethylene (PTFE, Teflon)
- Color natural
- Suitable for screw-joints and plug connectors of the programs 10, 14A, 15A and 17
- Temperature range -35 ° up to +120 °C
- Suitable for vacuum

Part no.	Outside ø / Inside ø	max. perm. pressure		min. permissible bending radius R	g / m
		20 °C	120 °C		
01-0402	4 / 2	15 bar	12 bar	15	23.8
01-0503	5 / 3	15 bar	9 bar	20	32.3
01-0604	6 / 4	12 bar	7 bar	30	41.9
01-0806	8 / 6	8 bar	5 bar	45	55.3

**Compressed-air hose**

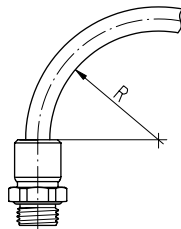

- Fluorethylenpropylene (FEP)
- Color crystal-clear
- very flexible
- Suitable for screw-joints and plug connectors of the programs 10, 14A, 15A and 17
- Temperature range -35 ° up to +120 °C
- Suitable for vacuum

Part no.	Outside ø / Inside ø	max. perm. pressure		min. permissible bending radius R	g / m
		20 °C	120 °C		
501-0402	4 / 2	15 bar	12 bar	15	23.8
501-0503	5 / 3	15 bar	9 bar	20	32.3
501-0604	6 / 4	12 bar	7 bar	30	41.9
501-0806	8 / 6	8 bar	5 bar	45	55.3

**Notice**

Eisele Flamex hose is resistant against all forms of weld spatters.  
Eisele compressed-air hoses are supplied exclusively on reels of 50 m.

## Compressed-air hose

- PVC reinforced
- Color blue, other colors on request
- Suitable for screw-joints of the program 10
- Temperature range -20° up to +50 °C

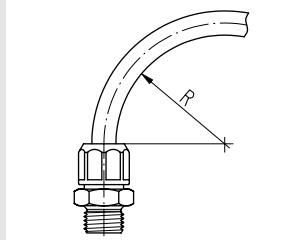

10A

Part no.	Outside $\varnothing$ / Inside $\varnothing$	max. permissible pressure	min. permissible bending radius R	g / m
06-0604	6.2/4	10 bar	50	19.5
06-0806	8.2/6	10 bar	60	32.7
06-1008	10/8	10 bar	65	40.5
06-1109	11.6/9	10 bar	70	51.8
06-1210	12.5/10	10 bar	80	51.9
06-1512	15/12	10 bar	100	69.3
06-1713	17.6/13	10 bar	100	140.1

## Compressed-air hose

- PVC with fabric lining
- Color green-transparent
- Suitable for screw-joints and hose nozzles on pages 76, 77, 226-229
- Temperature range -20° up to +50 °C

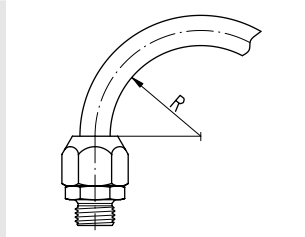

Part no.	Outside $\varnothing$ / Inside $\varnothing$	max. permissible pressure	min. permissible bending radius R	g / m
07-1004	10/4	12 bar	20	76.9
07-1206	12/6	12 bar	25	98.7
07-1408	14/8	12 bar	30	114.1
07-1509	15/9	12 bar	35	132.8
07-1610	16/10	10 bar	40	146.6
07-2112	21/12	10 bar	55	274.8
07-2013	20/13	10 bar	70	207.3

## Compressed-air hose

- Perbunan (NBR) with metal braiding
- Color silver
- Suitable for screw-joints on page 79
- Temperature range -20° up to +80 °C

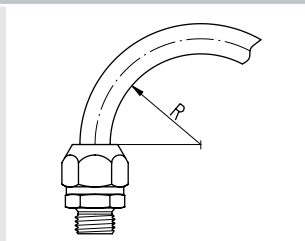

Part no.	Outside $\varnothing$ / Inside $\varnothing$	max. permissible pressure	min. permissible bending radius R	g / m
09-0704	7/4	12 bar	70	82.0
09-0906	9/6	12 bar	80	117.4
09-1209	12/9	12 bar	85	173.0

## Double-compressed-air hose

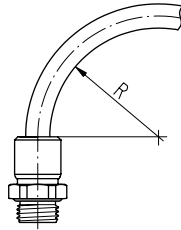

- Polyurethane (PU)
- Color black / blue
- Suitable for screw-joints of the program 10 and hose nozzles on pages 226 and 229 and of the program 18
- Temperature range -35° up to +60 °C
- Suitable for vacuum

Part no.	Outside $\varnothing$ / Inside $\varnothing$	max. permissible pressure	min. permissible bending radius R	g / m
02-4303	4.3/3 - 4.3/3	7 bar	15	19.6
02-0604	6/4 - 6/4	8 bar	30	40.4
02-0806	8/6 - 8/6	7 bar	45	62.0

## Spring coil

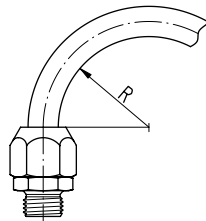
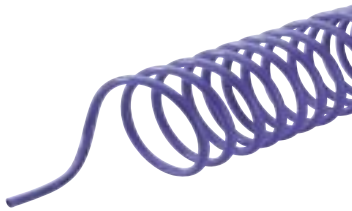

- with axial outlet
- Polyamide (PA)
- Color blue
- Suitable for screw-joints and plug connectors of the programs 10, 12, 14, 14A, 15, 15A and 17
- Temperature range -20° up to +70 °C
- Suitable for vacuum

Part no.	Outside $\varnothing$ / Inside $\varnothing$	max. perm. pressure	min. permissible bending radius R	working length	coil $\varnothing$ inside	g / piece
505-602504	6/4	15 bar	40	2500	60	280
505-605004	6/4	15 bar	40	5000	60	560
505-802506	8/6	12 bar	55	2500	80	390
505-805006	8/6	12 bar	55	5000	80	780

## Spring coil

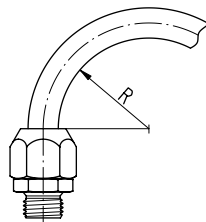
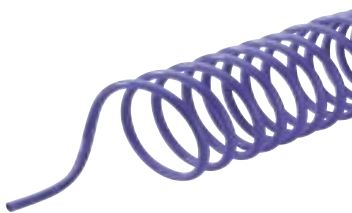

- with axial outlet
- Polyurethane (PU)
- Color blue
- Suitable for screw-joints and plug connectors of the programs 10, 12, 14, 14A, 15, 15A and 17
- Temperature range -15° up to +55 °C
- Suitable for vacuum

Part no.	Outside $\varnothing$ / Inside $\varnothing$	max. perm. pressure	min. permissible bending radius R	working length	coil $\varnothing$ inside	g / piece
503-402504	6/4	8 bar	30	2500	40	280
503-405004	6/4	8 bar	30	5000	40	560
503-502506	8/6	7 bar	45	2500	50	390
503-505006	8/6	7 bar	45	5000	50	780

### Notice

Because the bonded hoses of the double-compressed-air hose must be separated in the connection area, it may lead to leakage in use of plug connectors due to adhesive residue.

Eisele spring coils are supplied in packaging units of 1 piece.

## Spiral wrap for tubing

- Polyethylene (PE)
- Color natural
- Temperature range  $-10^{\circ}$  up to  $+40^{\circ}\text{C}$

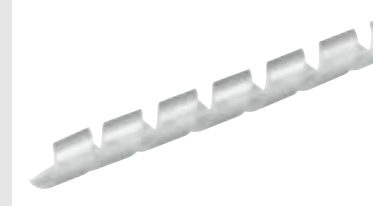

10A

Part no.	for the bundling of approx.		g / m
	Number of hoses	Outside $\varnothing$	
08-1209	20	5	50.1
	15	6	
	8	8	
	5	10	

Eisele spiral wraps for tubing are supplied exclusively in reels of 50 m.

## Tubing holder 10-fold

- with grooved pins
- Material PA6 GF, black
- Temperature range  $-10^{\circ}$  up to  $+40^{\circ}\text{C}$
- packaging unit of 10 pieces

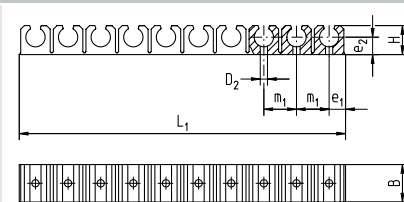

Part no.	for hose	B	H	L <sub>1</sub>	D <sub>2</sub>	e <sub>1</sub>	e <sub>2</sub>	m <sub>1</sub>	g/piece
12-0503	5/3	13.5	9	96	2.5	4.3	6	9.7	11
12-0604	6/4	13.5	9	105	3	5.2	5.5	10.5	11
12-0806	8/6	15.5	12	135	3	6.8	7.5	13.5	17
12-1109 <sup>1)</sup>	11.6/9	17.5	16.5	118	3.4	10.5	10	19.4	19

<sup>1)</sup> Tubing holder 6-fold

## Tubing cutter

- for compressed-air hoses to outside- $\varnothing$  of 14 mm
- Material plastic black, steel
- packaging unit of 1 piece



Part no.		g/piece
605-0014	Hose cutter up to outside- $\varnothing$ of 14 mm	30
605-0014 9	Replacement cutter up to outside- $\varnothing$ of 14 mm	1

## Tubing cutter

- for compressed-air hoses to outside- $\varnothing$  of 22 mm
- Material die-cast zinc, steel
- packaging unit of 1 piece



Part no.		g/piece
606-0022	Hose cutter up to outside- $\varnothing$ of 22 mm	240
606-0022 9	Replacement cutter up to outside- $\varnothing$ of 22 mm	2