



Section 4

Pressure regulators



P r e s s u r e r e g u l a t o r s

Series

Sandwich pressure regulator with manual adjust knob		PR37A
Sandwich pressure regulator with manual adjust knob		PR42A
Sandwich pressure regulator with manual adjust knob		PR47A
Sandwich pressure regulator with manual adjust knob		PR48A
Sandwich pressure regulator with air pilot adjust		
Sandwich pressure regulator with manual adjust knob		PR92C
Sandwich pressure regulator with manual adjust knob		
Sandwich pressure regulator with air pilot adjust		
Sandwich pressure regulator with manual adjust knob		PR93A
Sandwich pressure regulator with manual adjust knob		
Non plug-in sandwich pressure regulator with manual adjust knob		
Non plug-in sandwich pressure regulator with air pilot adjust		PRA1A
Plug-in sandwich pressure regulator with manual adjust knob		
Plug-in sandwich pressure regulator with air pilot adjust		PRP1A
Non plug-in sandwich pressure regulator with manual adjust knob		
Non plug-in sandwich pressure regulator with air pilot adjust		PRA2D
Plug-in sandwich pressure regulator with manual adjust knob		
Plug-in sandwich pressure regulator with air pilot adjust		PRP2B
Non plug-in sandwich pressure regulator with manual adjust knob		
Non plug-in sandwich pressure regulator with air pilot adjust		PRA3C
Plug-in sandwich pressure regulator with manual adjust knob		
Plug-in sandwich pressure regulator with air pilot adjust		PRP3B

Sandwich pressure regulator with manual adjust knob

OPERATIONAL BENEFITS

1. Easy mounting: saves on installation costs in comparison with inline regulators.
2. Compact all-included units.
3. Large orifice provides high flow.
4. Various functions available.
5. Simple, reliable and solid design.



PR37A

PR42A

PR47A

PR48A

PR92C

HOW TO ORDER

REGULATORS FOR "NON PLUG-IN" VALVES (CODED FOR KNOB ADJUSTMENT)

Gauge	Single pressure
No gauge port	PR37A-FAAA
With gauge Port (plugged)	PR37A-FABA

Note: Regulating pressure range for above models is 0 to 8 bar
For other ranges, see technical data page.

OPTIONS

Adjustment :

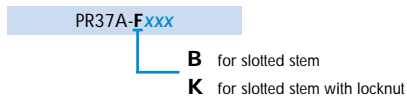

Pressure range :

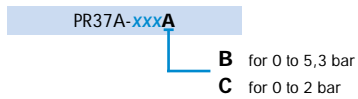

PR93A

PRA1A

PRP1A

PRA2D

PRP2B

PRA3C

PRP3B

TECHNICAL DATA

Fluid :	Compressed air, inert gases
Pressure range :	0 to 8 bar
Regulating range :	0 to 8 bar
Lubrication :	Not required, if used select a medium aniline point lubricant (between 80°C and 100°C)
Filtration :	40 μ
Temperature range :	-18°C to +50°C
Flow (at 6 bar, ΔP=1bar)	400 NI/min (Cv 0.4)

- Spare parts :
- Pressure regulator (less sandwich block) : PR37A-GOAA (knob), PR37A-COAA (slotted stem), PR37A-LOAA (slotted stem with locknut)
 - Gauges : 24177-160 (0 to 10,7 bar, 23 mm)
24177-100 (0 to 6,7 bar, 23 mm)
24177-060 (0 to 4 bar, 23 mm)

DIMENSIONS

Dimensions shown are metric (mm)

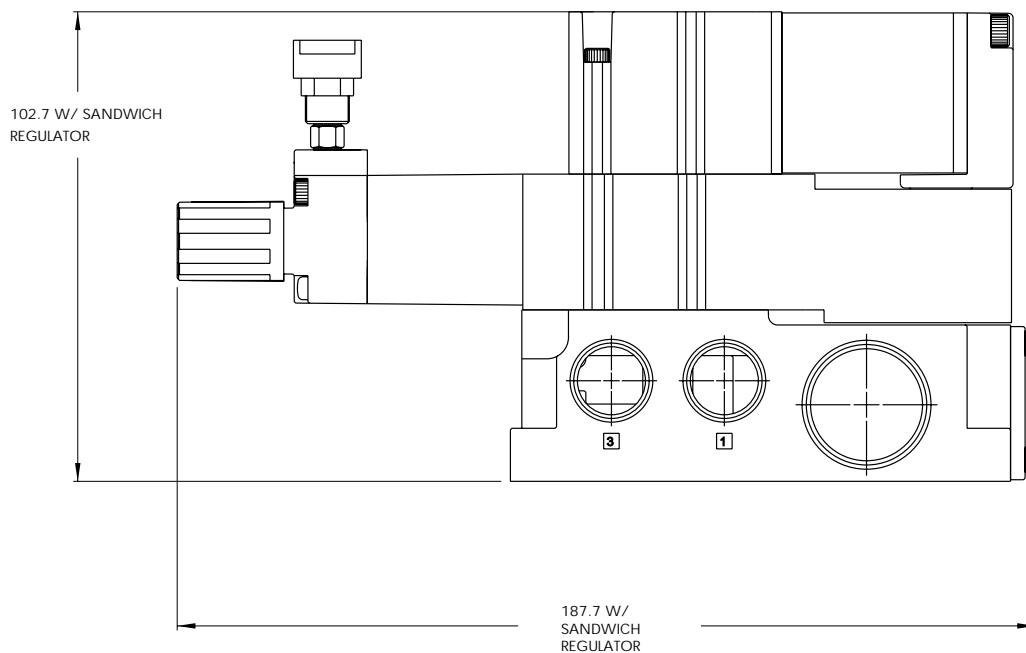

Sandwich pressure regulator with manual adjust knob

OPERATIONAL BENEFITS

1. Easy mounting: saves on installation costs in comparison with inline regulators.
2. Compact all-included units.
3. Large orifice provides high flow.
4. Various functions available.
5. Simple, reliable and solid design.



PR37A

PR42A

PR47A

PR48A

PR92C

HOW TO ORDER

NON PLUG-IN SANDWICH REGULATORS

Gauge	Regulator " 12" end Internal pilot	Regulator " 12" end External pilot
No gauge port	PR42A-BAAA	PR42A-BBAA
With gauge Port	PR42A-BABA	PR42A-BBBA

PR93A

PLUG-IN SANDWICH REGULATORS

Gauge	Regulator " 12" end Internal pilot	Regulator " 12" end External pilot
No gauge port	PR42A-AAAA	PR42A-ABAA
With gauge Port	PR42A-AABA	PR42A-ABBA

PRA1A

Notes:

- External pilot regulator required only when supply pressure (primary) to the valve is below the minimum operating pressure of the 42 series valve.
- When an internal pilot regulator is used with the 42 series valve, the valve should be ordered as external pilot and the base should be ordered as internal pilot. This ensures that the pilot supply is not regulated. If an internal pilot valve and base are used with an internal pilot regulator, the pilot supply is regulated.

PRP1A

Example: Valve 42A-AM D -AA A -GxxP-xxx with PR42A-AAAA

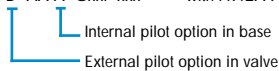

PRA2D

OPTIONS

Pressure range :

PR42A-AAA

- A** 0 to 8 bar
- B** 0 to 5,3 bar
- C** 0 to 2,7 bar

PRP2B

PRA3C

PRP3B

TECHNICAL DATA

Fluid :	Compressed air, inert gases
Pressure range :	0 to 8 bar
Regulating range :	0 to 8 bar
Lubrication :	Not required, if used select a medium aniline point lubricant (between 80°C and 100°C)
Filtration :	40 μ
Temperature range :	-18°C to +50°C
Flow (at 6 bar, ΔP=1bar) :	250 NI/min (Cv 0,25)

- Spare parts :
- Pressure regulator (less sandwich block) : PR42A-C0xx • Gauge port plug: N-PE003
 - M5 to 1/8" adapter : N-35005 • Gauge: 24177-160 (0 to 10,7 bar, 23 mm)
24177-100 (0 to 6,7 bar, 23 mm)
24177-060 (0 to 4 bar, 23 mm)

DIMENSIONS

Dimensions shown are metric (mm)

NON PLUG-IN

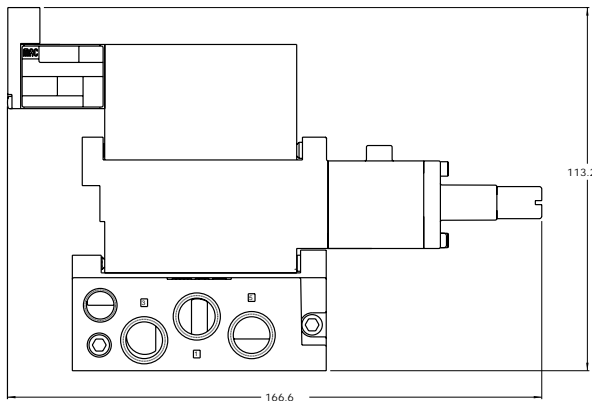

PLUG-IN

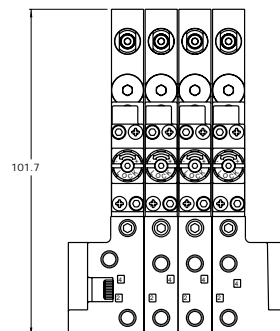
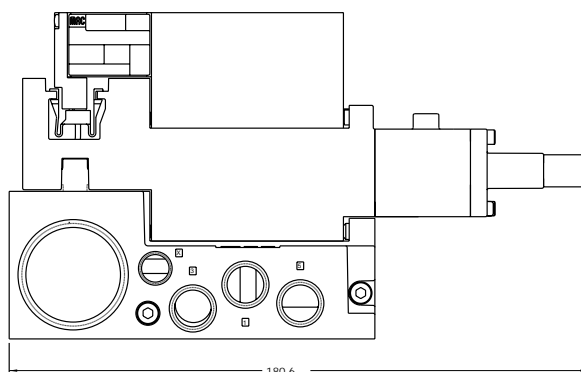

Consult "Precautions" before use, installation or service of MAC Valves..

Sandwich pressure regulator with manual adjust knob

OPERATIONAL BENEFITS

1. Easy mounting: saves on installation costs in comparison with inline regulators.
2. Compact all-included units.
3. Large orifice provides high flow.
4. Various functions available.
5. Simple, reliable and solid design.



PR37A

PR42A

PR47A

PR48A

PR92C

PR93A

PRA1A

PRP1A

PRA2D

PRP2B

PRA3C

PRP3B

HOW TO ORDER

REGULATORS FOR "PLUG-IN" VALVES (KNOB ADJUSTMENT)

Gauge	Single pressure
No gauge port	PR47A-EAAA
With gauge Port	PR47A-EABA

REGULATORS FOR "NON PLUG-IN" VALVES (KNOB ADJUSTMENT)

Gauge	Single pressure
No Gauge port	PR47A-FAAA
With Gauge Port	PR47A-FABA

OPTIONS

Pressure range :

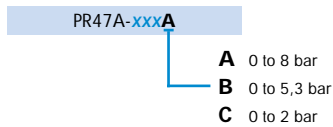

Adjustment for : Plug-in regulator

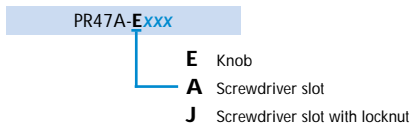

Non plug-in regulator

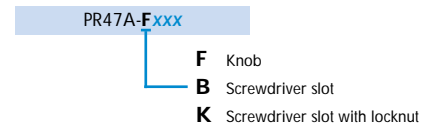

TECHNICAL DATA

Fluid :	Compressed air, inert gases
Pressure range :	0 to 8 bar
Regulating range :	0 to 8 bar
Lubrication :	Not required, if used select a medium aniline point lubricant (between 80°C and 100°C)
Filtration :	40 μ
Temperature range :	-18°C to +50°C
Flow (at 6 bar, ΔP=1bar):	400 NI/min (Cv 0.4)

- Spare parts :
- Pressure regulator (less sandwich block) : PR47A-G0xx (knob), PR47A-C0xx (screwdriver slot), PR47A-L0xx (screwdriver slot with locknut)
 - Gauge: 24177-160 (0 to 10,7 bar, 23 mm)
24177-100 (0 to 6,7 bar, 23 mm)
24177-060 (0 to 4 bar, 23 mm)

DIMENSIONS

Dimensions shown are metric (mm)

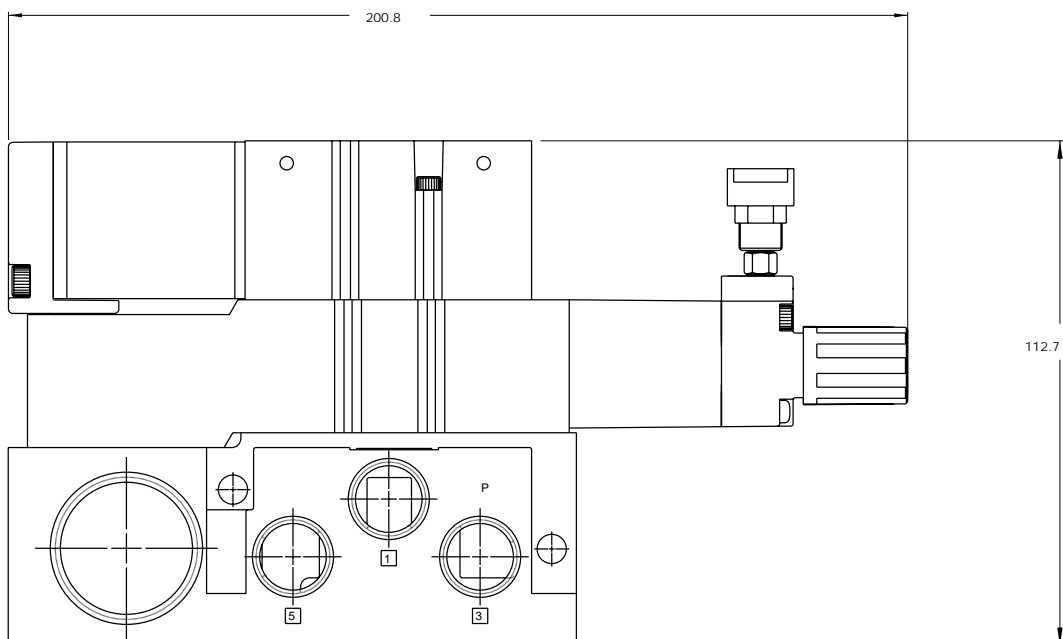

Sandwich pressure regulator with manual adjust knob

OPERATIONAL BENEFITS

1. Easy mounting: saves on installation costs in comparison with inline regulators.
2. Compact all-included units.
3. Large orifice provides high flow.
4. Various functions available.
5. Simple, reliable and solid design.



PR37A
PR42A
PR47A
PR48A

HOW TO ORDER

NON PLUG-IN SANDWICH REGULATORS (KNOB ADJUSTMENT)

Gauge	Regulator " 12" end Internal pilot	Regulator " 12" end External pilot
Gauge port	PR48A-BAAA	PR48A-BBAA

PLUG-IN SANDWICH REGULATORS (KNOB ADJUSTMENT)

Gauge	Regulator " 12" end Internal pilot	Regulator " 12" end External pilot
Gauge port	PR48A-AAAA	PR48A-ABAA

PR92C
PR93A
PRA1A
PRP1A
PRA2D
PRP2B
PRA3C
PRP3B

Notes:

- External pilot regulator required only when supply pressure (primary) to the valve is below the minimum operating pressure of the 48 series valve.
- When an internal pilot regulator is used with the 48 series valve, the valve should be ordered as external pilot and the base should be ordered as internal pilot. This ensures that the pilot supply is not regulated. If an internal pilot valve and base are used with an internal pilot regulator, the pilot supply is regulated.

Example: Valve 48A-AM D-AA A-GxxP-xxx with PR48A-AAAA

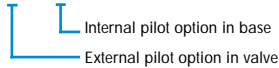

OPTIONS

Pressure range :

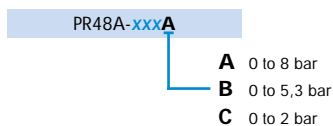

Adjustment for : Plug-in regulator

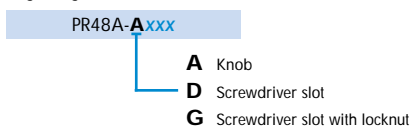

Non plug-in regulator

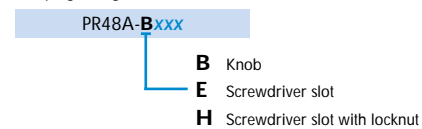

TECHNICAL DATA

Fluid :	Compressed air, inert gases
Pressure range :	0 to 8 bar
Regulating range :	0 to 8 bar
Lubrication :	Not required, if used select a medium aniline point lubricant (between 80°C and 100°C)
Filtration :	40 μ
Temperature range :	-18°C to +50°C
Flow (at 6 bar, ΔP=1bar) :	800 NI/min (Cv 0,8)

- Spare parts :
- Pressure regulator (less sandwich block) : PR48A-COxx (knob), PR48A-FOxx (screwdriver slot), PR48A-JOxx (screwdriver slot with locknut)
 - Gauge: 24177-160 (0 to 10,7 bar, 23 mm)
24177-100 (0 to 6,7 bar, 23 mm)
24177-060 (0 to 4 bar, 23 mm)

DIMENSIONS

Dimensions shown are metric (mm)

NON PLUG-IN

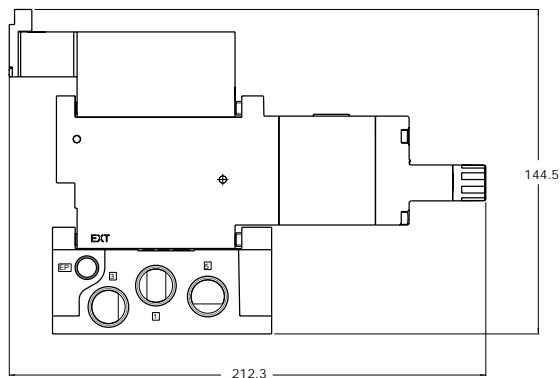

PLUG-IN

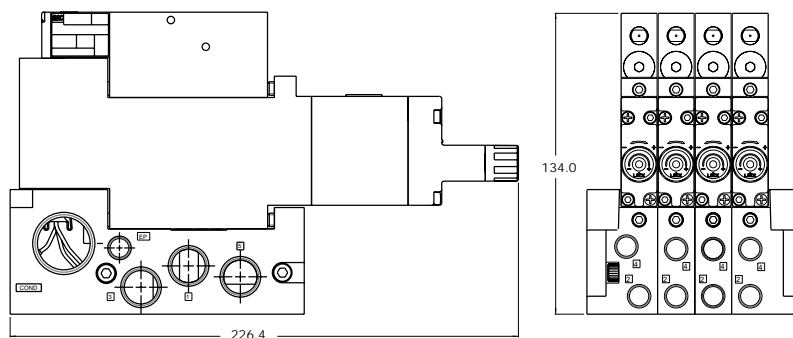

Sandwich pressure regulator with air pilot adjust

OPERATIONAL BENEFITS

1. Easy mounting: saves on installation costs in comparison with inline regulators.
2. Compact all-included units.
3. Large orifice provides high flow.
4. Various functions available.
5. Simple, reliable and solid design.



PR37A
PR42A
PR47A
PR48A
PR92C

HOW TO ORDER

REGULATORS FOR "PLUG-IN" VALVES

Gauge	Regulator A end Single pressure	Regulator B end Single pressure	Regulator A * end with by-pass end plate B end	Regulator B* end with by-pass end plate A end	Regulator * both ends
Gauge port only (plugged)	PR92C-EAAA	PR92C-EBAA	PR92C-ECAA	PR92C-EDAA	PR92C-EEAA
Gauge with face perpendicular to manual operator	PR92C-EABA	PR92C-EBBA	PR92C-ECBA	PR92C-EDBA	PR92C-EEBA
Gauge with face parallel to manual operator	PR92C-EACA	PR92C-EBCA	PR92C-ECCA	PR92C-EDCA	PR92C-EECA

PR93A
PRA1A

Note: above models are coded for use with single solenoid valves

REGULATORS FOR "PLUG-IN" VALVES

Gauge	Regulator A end Single pressure	Regulator B end Single pressure	Regulator A * end with by-pass end plate B end	Regulator B* end with by-pass end plate A end	Regulator * both ends
Gauge port only (plugged)	PR92C-GAAA	PR92C-GBAA	PR92C-GCAA	PR92C-GDAA	PR92C-GEAA
Gauge with face perpendicular to manual operator	PR92C-GABA	PR92C-GBBA	PR92C-GCBA	PR92C-GDBA	PR92C-GEBA
Gauge with face parallel to manual operator	PR92C-GACA	PR92C-GBCA	PR92C-GCCA	PR92C-GDCA	PR92C-GECA

PRP1A
PRA2D
PRP2B

* For use with dual pressure valves.

PLUG-IN OPTIONS

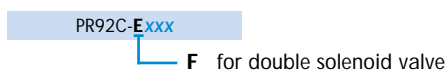

PRA3C
PRP3B

TECHNICAL DATA

Fluid :	Compressed air, inert gases
Pressure range :	0 to 8 bar
Regulating range :	0 to 8 bar
Lubrication :	Not required, if used select a medium aniline point lubricant (between 80°C and 100°C)
Filtration :	40 μ
Temperature range :	-18°C to +50°C
Flow (at 6 bar, ΔP=1bar) :	800 NI/min (Cv 0.8)

- Spare parts :
- R-92003 : regulator end plate kit • Gauge kit 0 - 10,7 bar: N-92006-01
 - R-92003-01 : regulator by-pass end plate kit
 - Pressure regulator (less sandwich block) : PR92C-HOAA

DIMENSIONS

Dimensions shown are metric (mm)

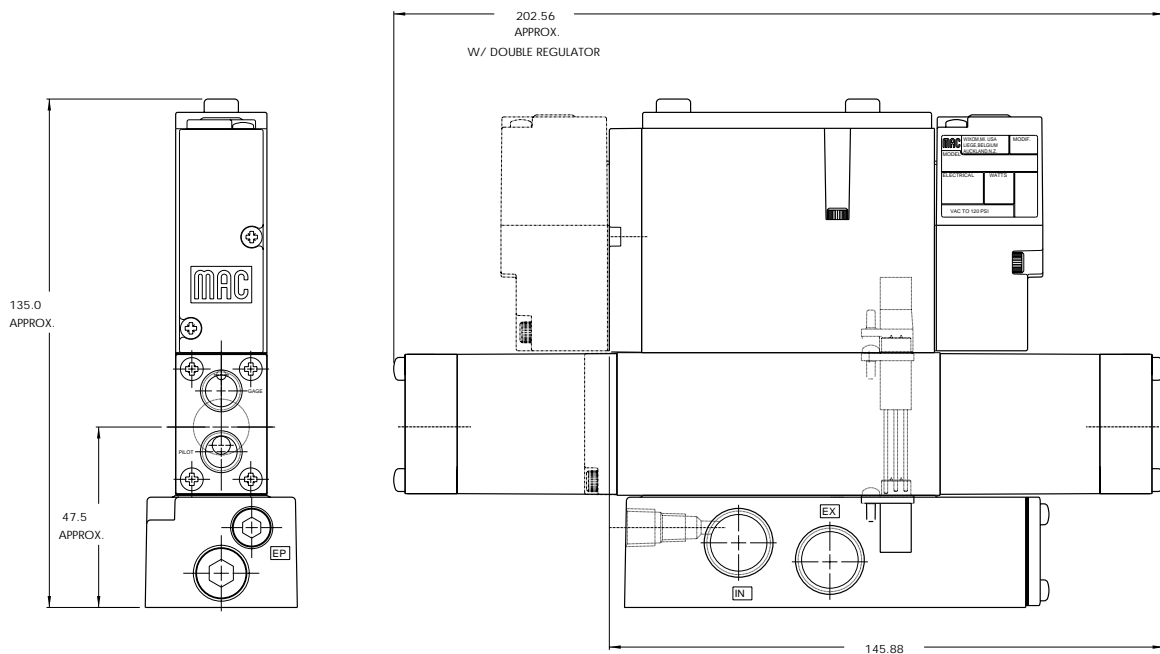

Sandwich pressure regulator with manual adjust knob

OPERATIONAL BENEFITS

1. Easy mounting: saves on installation costs in comparison with inline regulators.
2. Compact all-included units.
3. Large orifice provides high flow.
4. Various functions available.
5. Simple, reliable and solid design.



PR37A
PR42A
PR47A
PR48A
PR92C

HOW TO ORDER

REGULATORS FOR "PLUG-IN" VALVES (CODED FOR KNOB ADJUSTMENT)

Gauge	Select to A port Regulator A end By-pass plate B end	Select to B port Regulator B end By-pass plate A end	Select to A port Reg. both ends A end low press. B end high press.	Select to B port Reg. both ends A end high press. B end low press.
No Gauge	PR92C-JPAA	PR92C-JRAA	PR92C-JSAA	PR92C-JTAA
Gauge with face perpendicular to manual operator	PR92C-JPBA	PR92C-JRBA	PR92C-JSBA	PR92C-JTBA
Gauge with face parallel to manual operator	PR92C-JPCA	PR92C-JRCA	PR92C-JSCA	PR92C-JTCA

PR93A
PRA1A

Note: above models are coded for use with single solenoid valves

REGULATORS FOR "NON PLUG-IN" VALVES (CODED FOR KNOB ADJUSTMENT)

Gauge	Select to A port Regulator A end By-pass plate B end	Select to B port Regulator B end By-pass plate A end	Select to A port Reg. both ends A end low press. B end high press.	Select to B port Reg. both ends A end high press. B end low press.
No Gauge	PR92C-LPAA	PR92C-LRAA	PR92C-LSAA	PR92C-LTAA
Gauge with face perpendicular to manual operator	PR92C-LPBA	PR92C-LRBA	PR92C-LSBA	PR92C-LTBA
Gauge with face parallel to manual operator	PR92C-LPCA	PR92C-LRCA	PR92C-LSCA	PR92C-LTCA

PRP1A
PRA2D
PRP2B

Notes: - Regulating range for above models is 0 to 8 bar. For other ranges, see technical data page
- Use single pressure valve for all above models.

OPTIONS

Regulator less sandwich block

- PR92C-x0xx
- M** Knob
 - D** Slotted stem
 - S** Slotted stem with locknut

Other adjustment

- PR92C-xxxx
- A** Slotted stem, single solenoid
 - B** Slotted stem, double solenoid
 - C** Slotted stem, non plug-in
 - K** Knob, double solenoid
 - N** Slotted stem w/ locknut, single solenoid
 - P** Slotted stem w/ locknut, double solenoid
 - R** Slotted stem w/ locknut, non plug-in

PRA3C
PRP3B

TECHNICAL DATA

Fluid :	Compressed air, inert gases
Pressure range :	0 to 8 bar
Regulating range :	0 to 8 bar
Lubrication :	Not required, if used select a medium aniline point lubricant (between 80°C and 100°C)
Filtration :	40 μ
Temperature range :	-18°C to +50°C
Flow (at 6 bar, ΔP=1bar):	800 NI/min (Cv 0.8)

- Spare parts :
- R-92003 : end plate kit • R-92003-01: by-pass end plate kit
 - Gauge kit 0 – 10,7 bar: N-92006-01 • Gauge kit 0 – 6,7 bar: N-92006-02
 - Gauge kit 0-4 bar: N-92006-03

- Options:
- Pressure range: PR92C-xxxA (A 0 to 8 bar)
 - B 0 to 5,3 bar
 - C 0 to 2 bar
 - D 0 to 8 bar "A" end, 0 to 5,3 bar "B" end
 - E 0 to 8 bar "B" end, 0 to 5,3 bar "A" end
 - F 0 to 8 bar "A" end, 0 to 2 bar "B" end
 - G 0 to 8 bar "B" end, 0 to 2 bar "A" end
 - H 0 to 5,3 bar "A" end, 0 to 2 bar "B" end
 - J 0 to 5,3 bar "B" end, 0 to 2 bar "A" end

DIMENSIONS

Dimensions shown are metric (mm)

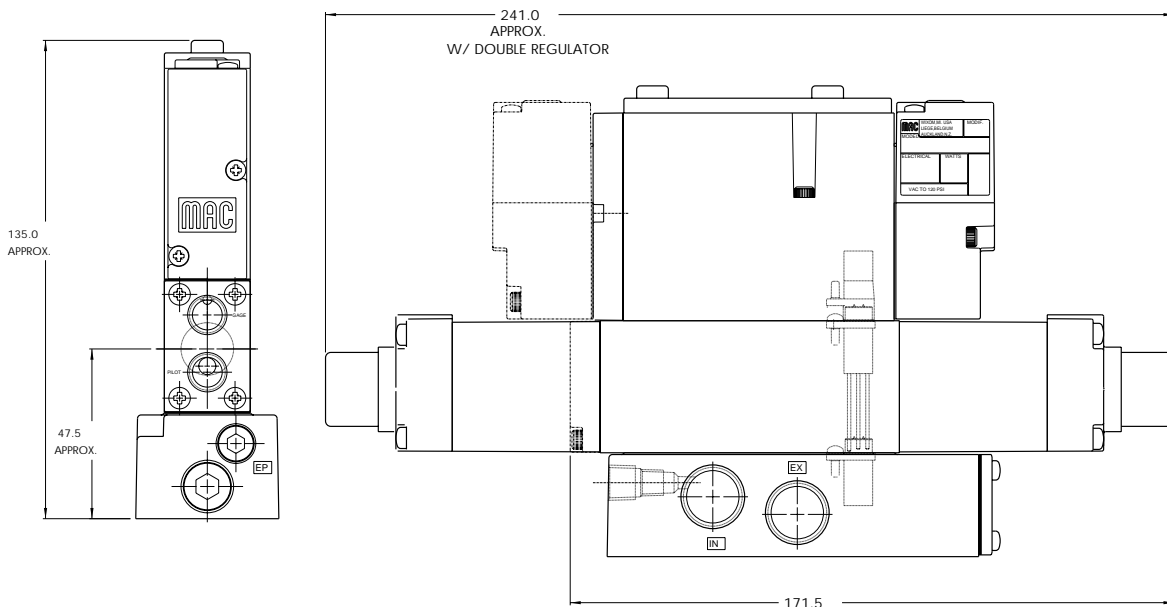

Sandwich pressure regulator with manual adjust knob

OPERATIONAL BENEFITS

1. Easy mounting: saves on installation costs in comparison with inline regulators.
2. Compact all-included units.
3. Large orifice provides high flow.
4. Various functions available.
5. Simple, reliable and solid design.



PR37A

PR42A

PR47A

PR48A

PR92C

HOW TO ORDER

REGULATORS FOR "PLUG-IN" VALVES

Gauge	Regulator A end Single pressure	Regulator B end Single pressure	Regulator A * end with by-pass end plate B end	Regulator B* end with by-pass end plate A end	Regulator * both ends
No Gauge	PR92C-JAAA	PR92C-JBAA	PR92C-JCAA	PR92C-JDAA	PR92C-JEAA
Gauge with face perpendicular to manual operator	PR92C-JABA	PR92C-JBBA	PR92C-JCBA	PR92C-JDBA	PR92C-JEBA
Gauge with face parallel to manual operator	PR92C-JACA	PR92C-JBCA	PR92C-JCCA	PR92C-JDCA	PR92C-JECA

PR93A

PRA1A

Note: above models are coded for use with single solenoid valves

REGULATORS FOR "PLUG-IN" VALVES

Gauge	Regulator A end Single pressure	Regulator B end Single pressure	Regulator A * end with by-pass end plate B end	Regulator B* end with by-pass end plate A end	Regulator * both ends
Gauge port only (plugged)	PR92C-LAAA	PR92C-LBAA	PR92C-LCAA	PR92C-LDAA	PR92C-LEAA
Gauge with face perpendicular to manual operator	PR92C-LABA	PR92C-LBBA	PR92C-LCBA	PR92C-LDBA	PR92C-LEBA
Gauge with face parallel to manual operator	PR92C-LACA	PR92C-LBCA	PR92C-LCCA	PR92C-LDCA	PR92C-LECA

PRP1A

PRA2D

PRP2B

* For use with dual pressure valves.

Note: Regulating range for above models is 0 to 8 bar. For other ranges, see technical data page.

OPTIONS

Regulator less sandwich block

PR92C-x0xx

- M** Knob
- D** Slotted stem
- S** Slotted stem with locknut

Other adjustment

PR92C-xxxx

- A** Slotted stem, single solenoid
- B** Slotted stem, double solenoid
- C** Slotted stem, non plug-in
- K** Knob, double solenoid
- N** Slotted stem w/ locknut, single solenoid
- P** Slotted stem w/ locknut, double solenoid
- R** Slotted stem w/ locknut, non plug-in

PRA3C

PRP3B

TECHNICAL DATA

Fluid :	Compressed air, inert gases
Pressure range :	0 to 8 bar
Regulating range :	0 to 8 bar
Lubrication :	Not required, if used select a medium aniline point lubricant (between 80°C and 100°C)
Filtration :	40 μ
Temperature range :	-18°C to +50°C
Flow (at 6 bar, ΔP=1bar):	800 NI/min (Cv 0.8)

- Spare parts :
- R-92003 : end plate kit • R-92003-01: by-pass end plate kit
 - Gauge kit 0 – 10,7 bar: N-92006-01 • Gauge kit 0 – 6,7 bar: N-92006-02
 - Gauge kit 0-4 bar: N-92006-03

- Options :
- Pressure range: PR92C-xxxA (A 0 to 8 bar)
 - B 0 to 5,3 bar
 - C 0 to 2 bar
 - D 0 to 8 bar "A" end, 0 to 5,3 bar "B" end
 - E 0 to 8 bar "B" end, 0 to 5,3 bar "A" end
 - F 0 to 8 bar "A" end, 0 to 2 bar "B" end
 - G 0 to 8 bar "B" end, 0 to 2 bar "A" end
 - H 0 to 5,3 bar "A" end, 0 to 2 bar "B" end
 - J 0 to 5,3 bar "B" end, 0 to 2 bar "A" end

DIMENSIONS

Dimensions shown are metric (mm)

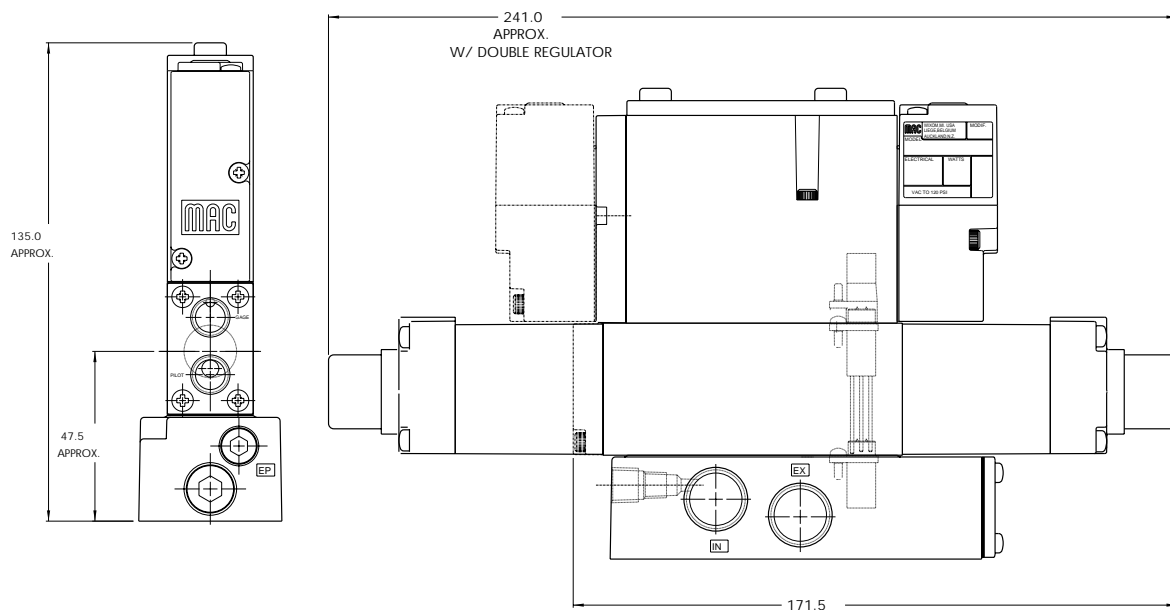



P r e s s u r e r e g u l a t o r s

Series

Sandwich pressure regulator with air pilot adjust

OPERATIONAL BENEFITS

1. Easy mounting: saves on installation costs in comparison with inline regulators.
2. Compact all-included units.
3. Large orifice provides high flow.
4. Various functions available.
5. Simple, reliable and solid design.

PR37A

PR42A

PR47A

PR48A

HOW TO ORDER

REGULATORS FOR "PLUG-IN" VALVES

Gauge	Regulator A end Single pressure	Regulator B end Single pressure	Regulator A * end with by-pass end plate B end	Regulator B* end with by-pass end plate A end	Regulator * both ends
Gauge port only (plugged)	PR93A-DAAA	PR93A-DBAA	PR93A-DCAA	PR93A-DDAA	PR93A-DEAA
Gauge with face perpendicular to manual operator	PR93A-DABA	PR93A-DBBA	PR93A-DCBA	PR93A-DDBA	PR93A-DEBA
Gauge with face parallel to manual operator	PR93A-DACA	PR93A-DBCA	PR93A-DCCA	PR93A-DDCA	PR93A-DECA

PR92C

PR93A

PRA1A

Note: above models are coded for use with single solenoid valves.

REGULATORS FOR "PLUG-IN" VALVES

Gauge	Regulator A end Single pressure	Regulator B end Single pressure	Regulator A * end with by-pass end plate B end	Regulator B* end with by-pass end plate A end	Regulator * both ends
Gauge port only (plugged)	PR93A-EAAA	PR93A-EBAA	PR93A-ECAA	PR93A-EDAA	PR93A-EEAA
Gauge with face perpendicular to manual operator	PR93A-EABA	PR93A-EBBA	PR93A-ECBA	PR93A-EDBA	PR93A-EEBA
Gauge with face parallel to manual operator	PR93A-EACA	PR93A-EBCA	PR93A-ECCA	PR93A-EDCA	PR93A-EECA

PRP1A

PRA2D

PRP2B

Note: Above models may be used with either single or double solenoid valves.

* For use with dual pressure valves.

PRA3C

PRP3B

TECHNICAL DATA

Fluid :	Compressed air, inert gases
Pressure range :	0 to 10 bar
Regulating range :	0 to 8 bar
Lubrication :	Not required, if used select a medium aniline point lubricant (between 80°C and 100°C)
Filtration :	40 μ
Temperature range :	-18°C to +50°C
Flow (at 6 bar, ΔP=1bar) :	2400 NI/min (Cv 2.4)

- Spare parts :
- Regulator end plate kit: R-93004
 - Regulator by-pass end plate kit: R-93004-01
 - Gauge kit: N-92006-01 (0 to 10,7 bar)
 - Pressure regulator (less sandwich block): PR93A-FOAA

DIMENSIONS

Dimensions shown are metric (mm)

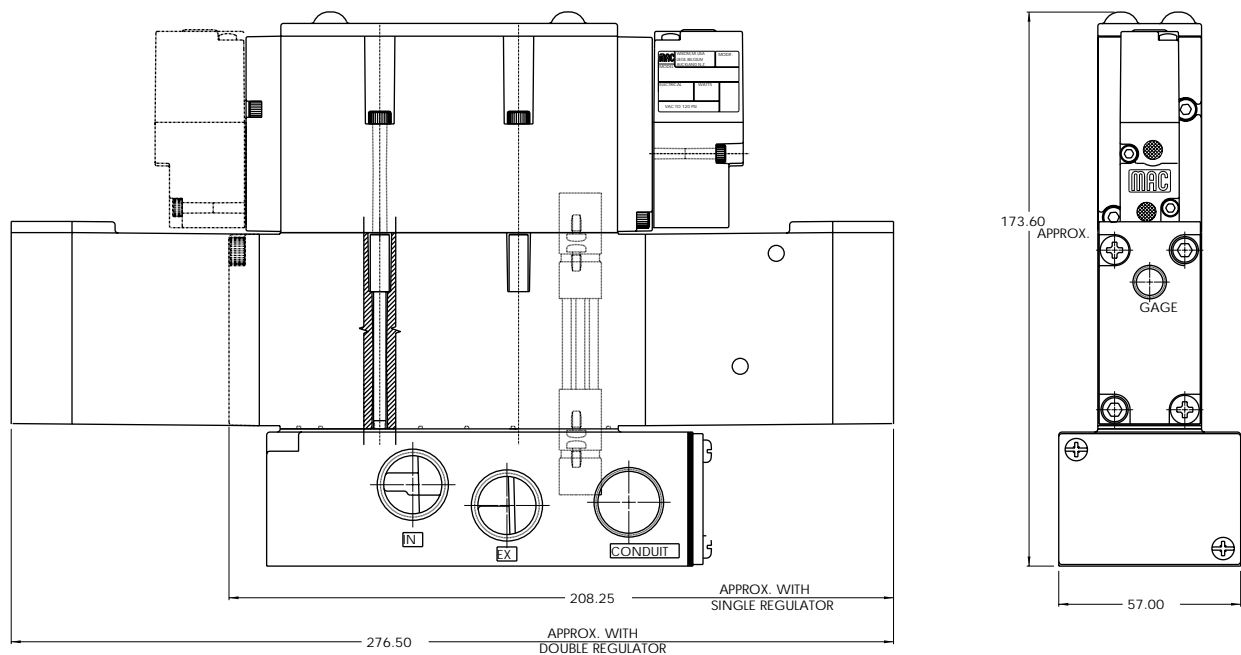

Sandwich pressure regulator with manual adjust knob

OPERATIONAL BENEFITS

1. Easy mounting: saves on installation costs in comparison with inline regulators.
2. Compact all-included units.
3. Large orifice provides high flow.
4. Various functions available.
5. Simple, reliable and solid design.



PR37A
PR42A
PR47A
PR48A
PR92C

HOW TO ORDER

REGULATORS FOR "PLUG-IN" VALVES (CODED FOR KNOB ADJUSTMENT)

Gauge	Select to A port Regulator A end By-pass plate B end	Select to B port Regulator B end By-pass plate A end	Select to A port Reg. both ends A end low press. B end high press.	Select to B port Reg. both ends A end high press. B end low press.
Gauge port only (plugged)	PR93A-GPAA	PR93A-GRAA	PR93A-GSAA	PR93A-GTAA
Gauge with face perpendicular to manual operator	PR93A-GPBA	PR93A-GRBA	PR93A-GSBA	PR93A-GTBA
Gauge with face parallel to manual operator	PR93A-GPCA	PR93A-GRCA	PR93A-GSCA	PR93A-GTCA

PR93A
PRA1A

REGULATORS FOR "NON PLUG-IN" VALVES

Gauge	Select to A port Regulator A end By-pass plate B end	Select to B port Regulator B end By-pass plate A end	Select to A port Reg. both ends A end low press. B end high press.	Select to B port Reg. both ends A end high press. B end low press.
Gauge port only (plugged)	PR93A-HPAA	PR93A-HRAA	PR93A-HSAA	PR93A-HTAA
Gauge with face perpendicular to manual operator	PR93A-HPBA	PR93A-HRBA	PR93A-HSBA	PR93A-HTBA
Gauge with face parallel to manual operator	PR93A-HPCA	PR93A-HRCA	PR93A-HSCA	PR93A-HTCA

PRP1A
PRA2D
PRP2B

Notes: - Regulating range for above models is 0 to 8 bar. For other ranges, see technical data page
- Use single pressure valve for all above models.

OPTIONS

Regulator less sandwich block

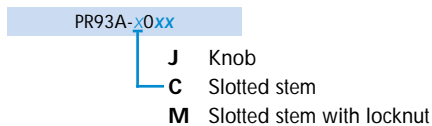

Other adjustment

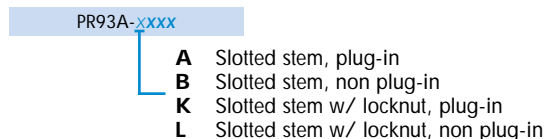

PRA3C
PRP3B

Note: Above models may be used with either single or double solenoid valves.

TECHNICAL DATA

Fluid :	Compressed air, inert gases
Pressure range :	0 to 10 bar
Regulating range :	0 to 8 bar
Lubrication :	Not required, if used select a medium aniline point lubricant (between 80°C and 100°C)
Filtration :	40 μ
Temperature range :	-18°C to +50°C
Flow (at 6 bar, ΔP=1bar):	2400 NI/min (Cv 2.4)

- Spare parts :
- R-93004 : end plate kit • R-93004-01: by-pass end plate kit
 - Gauge kit 0 – 10,7 bar: N-92006-01 • Gauge kit 0 – 6,7 bar: N-92006-02
 - Gauge kit 0-4 bar: N-92006-03

- Option:
- Pressure range: PR93A-xxxA (A 0 to 8 bar)

- B 0 to 5,3 bar
- C 0 to 2 bar
- D 0 to 8 bar "A" end, 0 to 5,3 bar "B" end
- E 0 to 8 bar "B" end, 0 to 5,3 bar "A" end
- F 0 to 8 bar "A" end, 0 to 2 bar "B" end
- G 0 to 8 bar "B" end, 0 to 2 bar "A" end
- H 0 to 5,3 bar "A" end, 0 to 2 bar "B" end
- J 0 to 5,3 bar "B" end, 0 to 2 bar "A" end

DIMENSIONS

Dimensions shown are metric (mm)

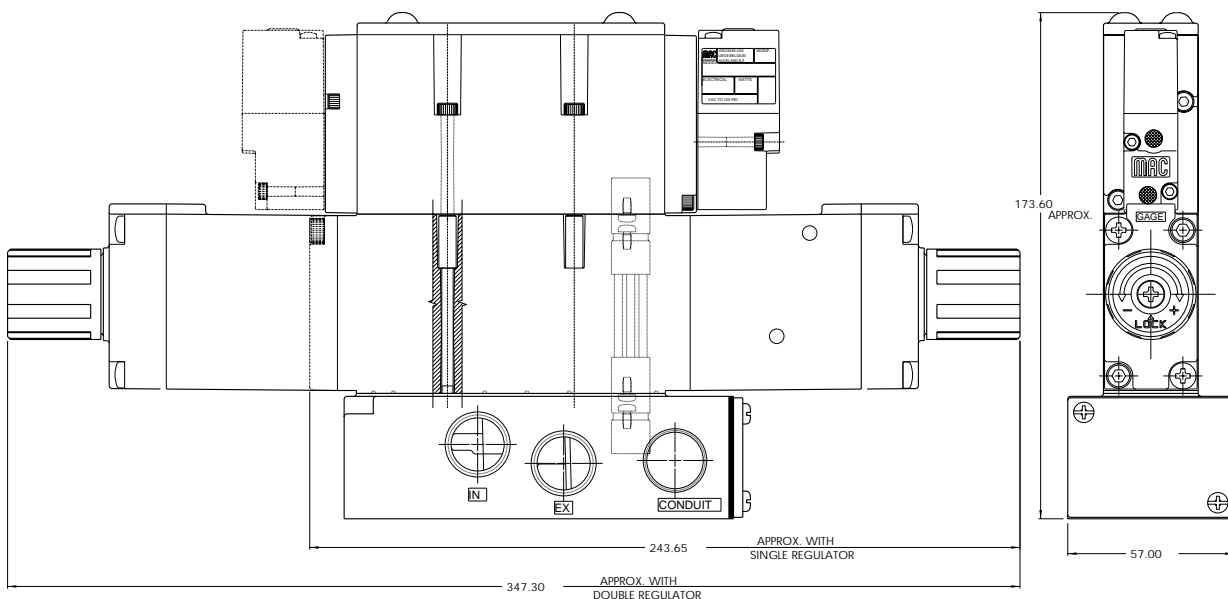

Sandwich pressure regulator with manual adjust knob

OPERATIONAL BENEFITS

1. Easy mounting: saves on installation costs in comparison with inline regulators.
2. Compact all-included units.
3. Large orifice provides high flow.
4. Various functions available.
5. Simple, reliable and solid design.



PR37A
PR42A
PR47A
PR48A
PR92C

HOW TO ORDER

REGULATORS FOR "PLUG-IN" VALVES (CODED FOR KNOB ADJUSTMENT)

Gauge	Regulator A end Single pressure	Regulator B end Single pressure	Regulator A * end with by-pass end plate B end	Regulator B* end with by-pass end plate A end	Regulator * both ends
Gauge port only (plugged)	PR93A-GAAA	PR93A-GBAA	PR93A-GCAA	PR93A-GDAA	PR93A-GEAA
Gauge with face perpendicular to manual operator	PR93A-GABA	PR93A-GBBA	PR93A-GCBA	PR93A-GDBA	PR93A-GEBA
Gauge with face parallel to manual operator	PR93A-GACA	PR93A-GBCA	PR93A-GCCA	PR93A-GDCA	PR93A-GECA

PR93A

PRA1A

Note: above models are coded for use with single solenoid valves.

REGULATORS FOR "NON PLUG-IN" VALVES (CODED FOR KNOB ADJUSTMENT)

Gauge	Regulator A end Single pressure	Regulator B end Single pressure	Regulator A * end with by-pass end plate B end	Regulator B* end with by-pass end plate A end	Regulator * both ends
Gauge port only (plugged)	PR93A-HAAA	PR93A-HBAA	PR93A-HCAA	PR93A-HDAA	PR93A-HEAA
Gauge with face perpendicular to manual operator	PR93A-HABA	PR93A-HBBA	PR93A-HCBA	PR93A-HDBA	PR93A-HEBA
Gauge with face parallel to manual operator	PR93A-HACA	PR93A-HBCA	PR93A-HCCA	PR93A-HDCA	PR93A-HECA

PRP1A

PRA2D

PRP2B

* For use with dual pressure valves.

Note: Regulating range for above models is 0 to 8 bar. For other ranges, see technical data page.

OPTIONS Regulator less sandwich block

PR93A-x0xx

- J Knob
- C Slotted stem
- M Slotted stem with locknut

Other adjustment

PR93A-xxxx

- A Slotted stem, plug-in
- B Slotted stem, non plug-in
- K Slotted stem w/ locknut, plug-in
- L Slotted stem w/ locknut, non plug-in

PRA3C

PRP3B

Note: Above models may be used with either single or double solenoid valves.

TECHNICAL DATA

Fluid :	Compressed air, inert gases
Pressure range :	0 to 10 bar
Regulating range :	0 to 8 bar
Lubrication :	Not required, if used select a medium aniline point lubricant (between 80°C and 100°C)
Filtration :	40 μ
Temperature range :	-18°C to +50°C
Flow (at 6 bar, ΔP=1bar):	2400 NI/min (Cv 2.4)

- Spare parts :
- R-93004 : end plate kit • R-93004-01: by-pass end plate kit
 - Gauge kit 0 – 10,7 bar: N-92006-01 • Gauge kit 0 – 6,7 bar: N-92006-02
 - Gauge kit 0-4 bar: N-92006-03

- Option:
- Pressure range: PR93A-xxxA (A 0 to 8 bar)

- B 0 to 5,3 bar
- C 0 to 2 bar
- D 0 to 8 bar "A" end, 0 to 5,3 bar "B" end
- E 0 to 8 bar "B" end, 0 to 5,3 bar "A" end
- F 0 to 8 bar "A" end, 0 to 2 bar "B" end
- G 0 to 8 bar "B" end, 0 to 2 bar "A" end
- H 0 to 5,3 bar "A" end, 0 to 2 bar "B" end
- J 0 to 5,3 bar "B" end, 0 to 2 bar "A" end

DIMENSIONS

Dimensions shown are metric (mm)

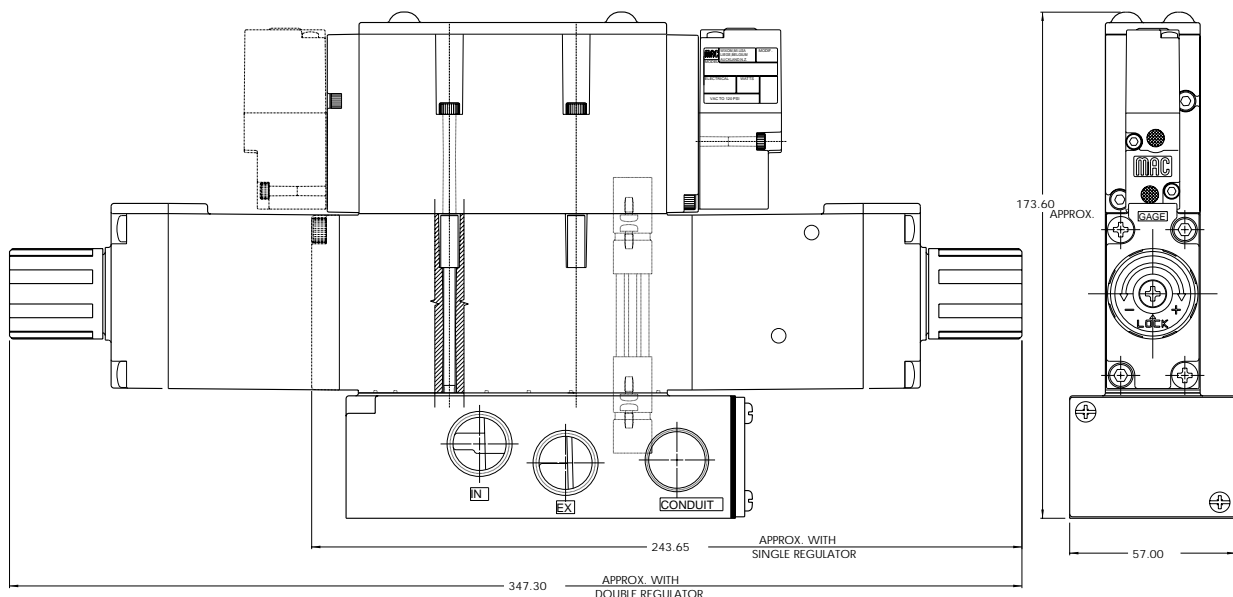

Non plug-in sandwich pressure regulator with manual adjust knob

OPERATIONAL BENEFITS

1. Easy mounting : saves on installation costs in comparison with inline regulators.
2. Allows to have compact, all-included units.
3. Large orifice provides high flow.
4. Various functions available.
5. Simple, reliable and solid design.



PR37A
PR42A
PR47A
PR48A
PR92C

HOW TO ORDER

INTERNAL PILOT

Gauge	Single pressure Regulator 14 end Same regulated pressure to ports 2 and 4	Single pressure Regulator 12 end Same regulated pressure to ports 2 and 4	Dual pressure Regulator 14 end Regulated pressure to port 4 *	Dual pressure Regulator 12 end Regulated pressure to port 2 *	Dual pressure Dual regulator Two regulated pressures to ports 2 and 4 *
No gauge	PRA1A-GAAA	PRA1A-GCAA	PRA1A-GBAA	PRA1A-GDAA	PRA1A-GEAA
Gauge perpendicular to regulator(s)	PRA1A-GABA	PRA1A-GCBA	PRA1A-GBBA	PRA1A-GDBA	PRA1A-GECA
Gauge parallel to regulator(s)	PRA1A-GADA	PRA1A-GCDA	PRA1A-GBDA	PRA1A-GDDA	PRA1A-GEEA

PR93A

PRA1A

EXTERNAL PILOT AND REMOTE AIR

Gauge	Single pressure Regulator 14 end Same regulated pressure to ports 2 and 4	Single pressure Regulator 12 end Same regulated pressure to ports 2 and 4	Dual pressure Regulator 14 end Regulated pressure to port 4 *	Dual pressure Regulator 12 end Regulated pressure to port 2 *	Dual pressure Dual regulator Two regulated pressures to ports 2 and 4 *
No gauge	PRA1A-HAAA	PRA1A-HCAA	PRA1A-HBAA	PRA1A-HDAA	PRA1A-HEAA
Gauge perpendicular to regulator(s)	PRA1A-HABA	PRA1A-HCBA	PRA1A-HBBA	PRA1A-HDBA	PRA1A-HECA
Gauge parallel to regulator(s)	PRA1A-HADA	PRA1A-HCDA	PRA1A-HBDA	PRA1A-HDDA	PRA1A-HEEA

PRP1A

PRA2D

PRP2B

* - To be used with dual pressure valves.
Note : regulating range for above models is 0-8 bar. For other ranges see technical data page.

Main valve body assembly must be external pilot model. Pilots are supplied internally from primary pressure in regulator block. Cannot field convert regulator block from Single Pressure to dual pressure. Body/Block to base mounting screw #35336.

ADJUSTMENT OPTIONS

PRA1A-xxxx

- A** for slotted stem adjustment (internal pilot)
- B** for slotted stem adjustment (external/remote air)
- K** for slotted stem with locknut (internal pilot)
- L** for slotted stem with locknut (external/remote air)

PRA3C

PRP3B

TECHNICAL DATA

Fluid :	Compressed air, inert gases
Pressure range :	0 to 10 bar
Regulating range :	0 to 8 bar (other ranges see below)
Lubrication :	Not required, if used select a medium aniline point lubricant (between 80°C to 100°C)
Filtration :	40 μ
Temperature range :	-18°C to 50°C
Flow :	1000 NI/min (Cv 1.0)

- Spare parts :
- Pressure regulator (less sandwich block) : PRA1A-JOAA (KNOB), PRA1A-COAA (SLOTTED STEM), PRA1A-MOAA (SLOTTED STEM WITH LOCKNUT).
 - Gauge : N-82016-01 (0-8 bar perpendicular)
N-82016-02 (0-8 bar parallel)
N-82016-03 (0-5,3 bar perpendicular)
N-82016-04 (0-5,3 bar parallel)
N-82016-05 (0-2 bar perpendicular)
N-82016-06 (0-2 bar parallel)

Regulating range options : PRA1A-XXXXA

- Replace by B - 0 to 5,3 bar
- Replace by C - 0 to 2 bar
- Replace by D - 0 to 8 bar on "14" end - 0 to 5,3 bar on "12" end
- Replace by E - 0 to 8 bar on "12" end - 0 to 5,3 bar on "14" end
- Replace by F - 0 to 8 bar on "14" end - 0 to 2 bar on "12" end
- Replace by G - 0 to 8 bar on "12" end - 0 to 2 bar on "14" end
- Replace by H - 0 to 5,3 bar on "14" end - 0 to 2 bar on "12" end
- Replace by J - 0 to 5,3 bar on "12" end - 0 to 2 bar on "14" end

DIMENSIONS

Dimensions shown are metric (mm)

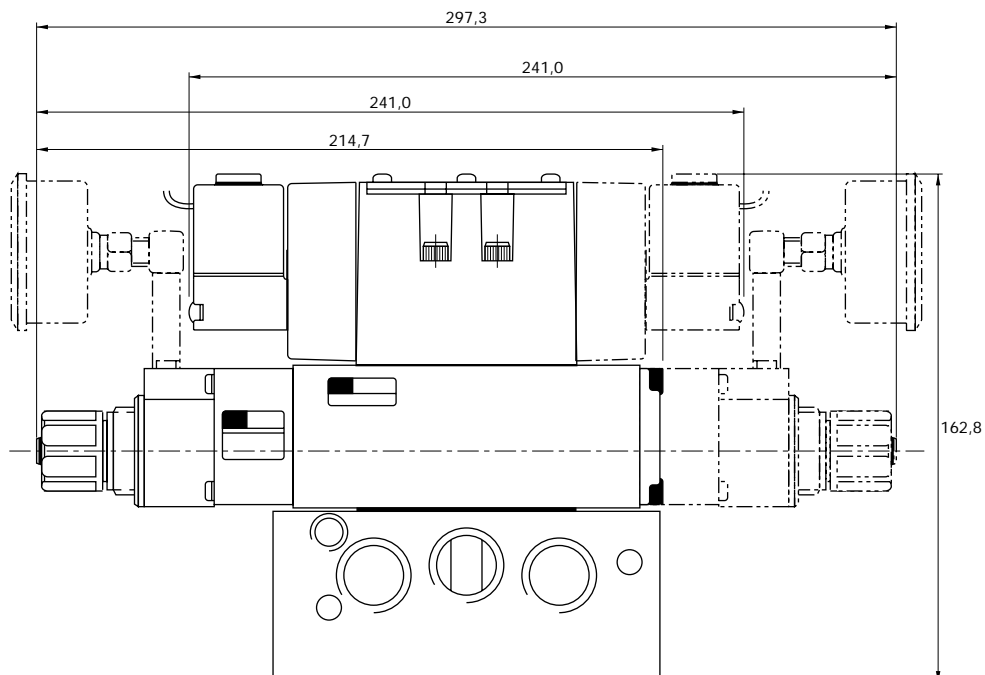

Non plug-in sandwich pressure regulator with air pilot adjust

OPERATIONAL BENEFITS

1. Easy mounting : saves on installation costs in comparison with inline regulators.
2. Allows to have compact, all-included units.
3. Large orifice provides high flow.
4. Various functions available.
5. Simple, reliable and solid design.



PR37A
PR42A
PR47A
PR48A
PR92C

HOW TO ORDER

INTERNAL PILOT

Gauge	Single pressure Regulator 14 end Same regulated pressure to ports 2 and 4	Single pressure Regulator 12 end Same regulated pressure to ports 2 and 4	Dual pressure Regulator 14 end Regulated pressure to port 4 *	Dual pressure Regulator 12 end Regulated pressure to port 2 *	Dual pressure Dual regulator Two regulated pressures to ports 2 and 4 *
No gauge	PRA1A-DAAA	PRA1A-DCAA	PRA1A-DBAA	PRA1A-DDAA	PRA1A-DEAA
Gauge perpendicular to regulator(s)	PRA1A-DABA	PRA1A-DCBA	PRA1A-DBBA	PRA1A-DDBA	PRA1A-DECA
Gauge parallel to regulator(s)	PRA1A-DADA	PRA1A-DCDA	PRA1A-DBDA	PRA1A-DDDA	PRA1A-DEEA

PR93A

PRA1A

EXTERNAL PILOT AND REMOTE AIR

Gauge	Single pressure Regulator 14 end Same regulated pressure to ports 2 and 4	Single pressure Regulator 12 end Same regulated pressure to ports 2 and 4	Dual pressure Regulator 14 end Regulated pressure to port 4 *	Dual pressure Regulator 12 end Regulated pressure to port 2 *	Dual pressure Dual regulator Two regulated pressures to ports 2 and 4 *
No gauge	PRA1A-EAAA	PRA1A-ECAA	PRA1A-EBAA	PRA1A-EDAA	PRA1A-EEAA
Gauge perpendicular to regulator(s)	PRA1A-EABA	PRA1A-ECBA	PRA1A-EBBA	PRA1A-EDBA	PRA1A-EECA
Gauge parallel to regulator(s)	PRA1A-EADA	PRA1A-ECDA	PRA1A-EBDA	PRA1A-EDDA	PRA1A-EEEA

PRP1A

PRA2D

PRP2B

* - To be used with dual pressure valves.

Main valve body assembly must be external pilot model. Pilots are supplied internally from primary pressure in regulator block. Cannot field convert regulator block from Single Pressure to dual pressure. Body/Block to base mounting screw #35336.

PRA3C

PRP3B

TECHNICAL DATA

Fluid :	Compressed air, inert gases
Pressure range :	0 to 10 bar
Regulating range :	0 to 8 bar
Lubrication :	Not required, if used select a medium aniline point lubricant (between 80°C to 100°C)
Filtration :	40 μ
Temperature range :	-18°C to 50°C
Flow :	1000 NI/min (Cv 1.0)

Spare parts :

- Pressure regulator (less sandwich block) : PRA1A-F0AA.
- Gauge : N-82016-01 (0-8 bar perpendicular)
N-82016-02 (0-8 bar parallel)

DIMENSIONS

Dimensions shown are metric (mm)

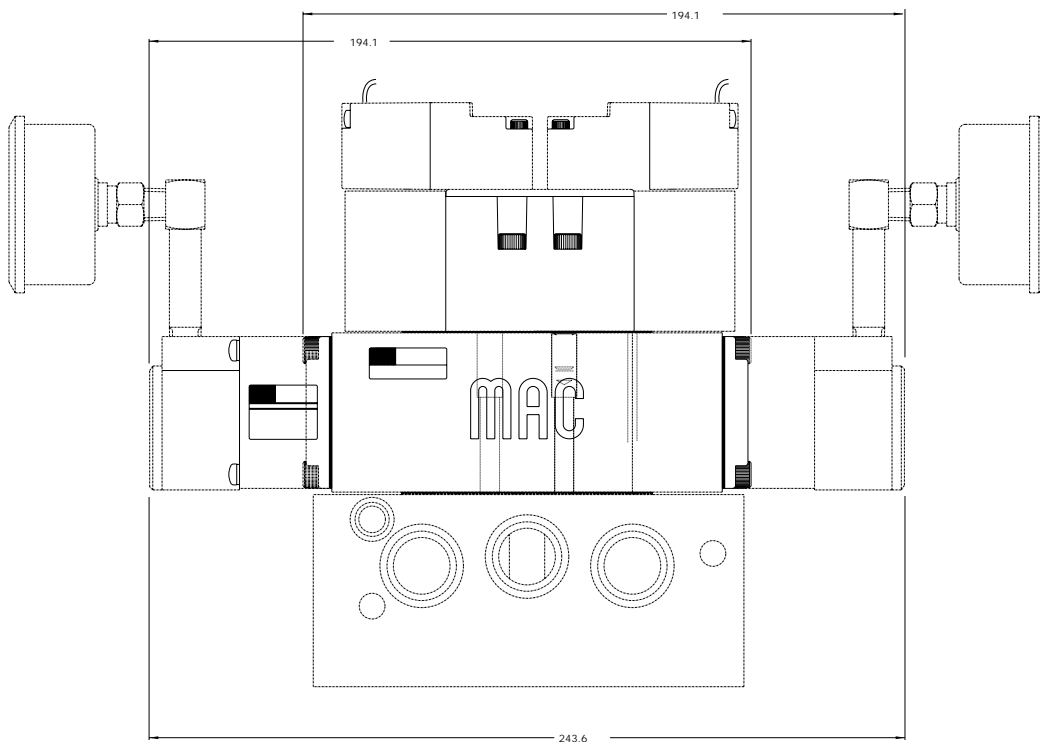

Plug-in sandwich pressure regulator with manual adjust knob

OPERATIONAL BENEFITS

1. Easy mounting: saves on installation costs in comparison with inline regulators.
2. Compact all-included units.
3. Large orifice provides high flow.
4. Various functions available.
5. Simple, reliable and solid design.



PR37A
PR42A
PR47A
PR48A
PR92C

HOW TO ORDER

REGULATORS FOR INTERNAL PILOT (CODED FOR KNOB ADJUSTMENT)

Gauge	Single pressure Regulator 14 end Same regulated pressure to ports 2 and 4	Single pressure Regulator 12 end Same regulated pressure to ports 2 and 4	Dual pressure Regulator 14 end Regulated pressure to port 4 *	Dual pressure Regulator 12 end Regulated pressure to port 2 *	Dual pressure Dual regulator Two regulated pressures to ports 2 and 4 *
Gauge port only	PRP1A-GAKA	PRP1A-GCKA	PRP1A-GBKA	PRP1A-GDKA	PRP1A-GEKA
Gauge perpendicular to manual operator	PRP1A-GABA	PRP1A-GCBA	PRP1A-GBBA	PRP1A-GDBA	PRP1A-GECA
Gauge parallel to manual operator	PRP1A-GADA	PRP1A-GCDA	PRP1A-GBDA	PRP1A-GDDA	PRP1A-GEEA

PR93A
PRA1A

REGULATORS FOR EXTERNAL PILOT AND REMOTE AIR (CODED FOR KNOB ADJUSTMENT)

Gauge	Single pressure Regulator 14 end Same regulated pressure to ports 2 and 4	Single pressure Regulator 12 end Same regulated pressure to ports 2 and 4	Dual pressure Regulator 14 end Regulated pressure to port 4 *	Dual pressure Regulator 12 end Regulated pressure to port 2 *	Dual pressure Dual regulator Two regulated pressures to ports 2 and 4 *
No gauge	PRP1A-HAKA	PRP1A-HCKA	PRP1A-HBKA	PRP1A-HDKA	PRP1A-HEKA
Gauge perpendicular to manual operator	PRP1A-HABA	PRP1A-HCBA	PRP1A-HBBA	PRP1A-HDBA	PRP1A-HECA
Gauge parallel to manual operator	PRP1A-HADA	PRP1A-HCDA	PRP1A-HBDA	PRP1A-HDDA	PRP1A-HEEA

PRP1A
PRA2D
PRP2B

* For use with dual pressure valves.
Note: Regulating range for above models is 0-8 bar. For other ranges, see technical data page.

ADJUSTMENT OPTIONS

PRP1A-xxxx	A for slotted stem adjustment (internal pilot)
	B for slotted stem adjustment (external/remote air)
	K for slotted stem with locknut (internal pilot)
	L for slotted stem with locknut (external/remote air)

Notes:

1. Valves used with above models must be external pilot models.
2. Cannot field convert regulator block from single pressure to dual pressure.
3. Cannot field convert from internal pilot to external pilot.
4. Wired for double solenoid valves.

PRA3C
PRP3B

TECHNICAL DATA

Fluid :	Compressed air, inert gases
Pressure range :	0 to 10 bar
Regulating range :	0 to 8 bar
Lubrication :	Not required, if used select a medium aniline point lubricant (between 80°C and 100°C)
Filtration :	40 μ
Temperature range :	-18°C to +50°C
Flow (at 6 bar, ΔP=1bar) :	1100 NI/min (Cv 1.1)

Spare parts : • Pressure regulator (less sandwich block) : PRP1A-JOKA (knob), PRP1A-COKA (slotted stem)
PRP1A-MOKA (slotted stem with locknut)

Regulating range options : PRP1A-XXXX

- Replace by B - 0 to 5,3 bar
- Replace by C - 0 to 2 bar
- Replace by D - 0 to 8 bar on "14" end - 0 to 5,3 bar on "12" end
- Replace by E - 0 to 8 bar on "12" end - 0 to 5,3 bar on "14" end
- Replace by F - 0 to 8 bar on "14" end - 0 to 2 bar on "12" end
- Replace by G - 0 to 8 bar on "12" end - 0 to 2 bar on "14" end
- Replace by H - 0 to 5,3 bar on "14" end - 0 to 2 bar on "12" end
- Replace by J - 0 to 5,3 bar on "12" end - 0 to 2 bar on "14" end

DIMENSIONS

Dimensions shown are metric (mm)

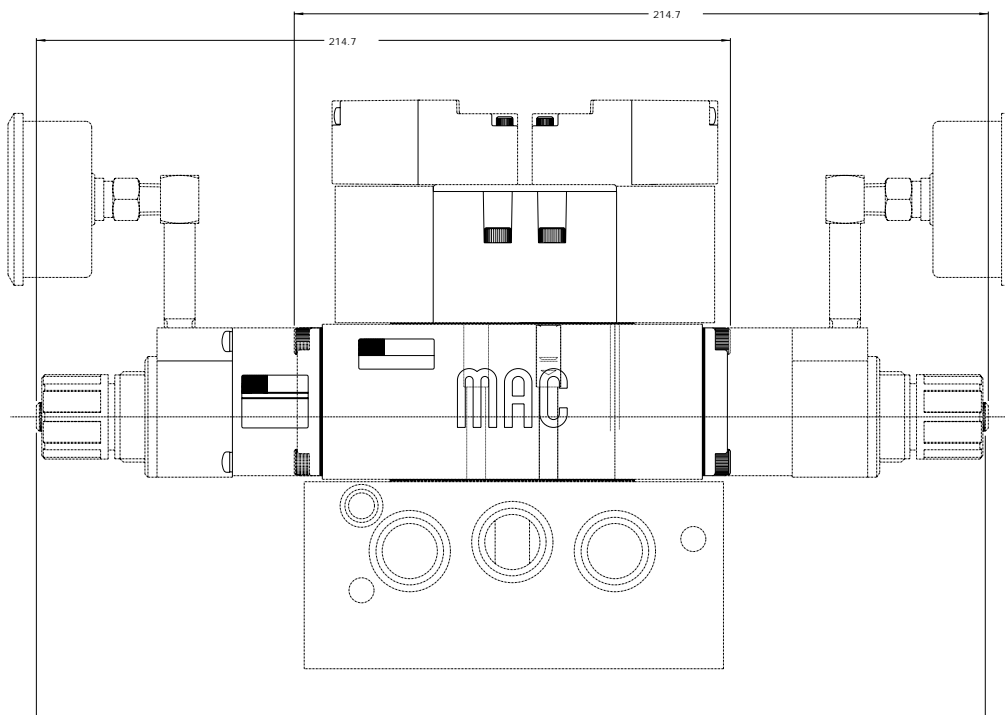

Plug-in sandwich pressure regulator with air pilot adjust

OPERATIONAL BENEFITS

1. Easy mounting: saves on installation costs in comparison with inline regulators.
2. Compact all-included units.
3. Large orifice provides high flow.
4. Various functions available.
5. Simple, reliable and solid design.



PR37A
PR42A
PR47A
PR48A
PR92C

HOW TO ORDER

REGULATORS FOR INTERNAL PILOT

Gauge	Single pressure Regulator 14 end Same regulated pressure to ports 2 and 4	Single pressure Regulator 12 end Same regulated pressure to ports 2 and 4	Dual pressure Regulator 14 end Regulated pressure to port 4 *	Dual pressure Regulator 12 end Regulated pressure to port 2 *	Dual pressure Dual regulator Two regulated pressures to ports 2 and 4 *
Gauge port only	PRP1A-DAKA	PRP1A-DCKA	PRP1A-DBKA	PRP1A-DDKA	PRP1A-DEKA
Gauge perpendicular to manual operator	PRP1A-DABA	PRP1A-DCBA	PRP1A-DBBA	PRP1A-DDBA	PRP1A-DECA
Gauge parallel to manual operator	PRP1A-DADA	PRP1A-DCDA	PRP1A-DBDA	PRP1A-DDDA	PRP1A-DEEA

PR93A
PRA1A

REGULATORS FOR EXTERNAL PILOT AND REMOTE AIR

Gauge	Single pressure Regulator 14 end Same regulated pressure to ports 2 and 4	Single pressure Regulator 12 end Same regulated pressure to ports 2 and 4	Dual pressure Regulator 14 end Regulated pressure to port 4 *	Dual pressure Regulator 12 end Regulated pressure to port 2 *	Dual pressure Dual regulator Two regulated pressures to ports 2 and 4 *
Gauge port only	PRP1A-EAKA	PRP1A-ECKA	PRP1A-EBKA	PRP1A-EDKA	PRP1A-EEKA
Gauge perpendicular to manual operator	PRP1A-EABA	PRP1A-ECBA	PRP1A-EBBA	PRP1A-EDBA	PRP1A-EECA
Gauge parallel to manual operator	PRP1A-EADA	PRP1A-ECDA	PRP1A-EBDA	PRP1A-EDDA	PRP1A-EEEA

PRP1A
PRA2D
PRP2B

* - To be used with dual pressure valves.

Notes:

1. Valves used with above models must be external pilot models.
2. Cannot field convert regulator block from single pressure to dual pressure.
3. Cannot field convert from internal pilot to external pilot.
4. Wired for double solenoid valves.

PRA3C
PRP3B

TECHNICAL DATA

Fluid :	Compressed air, inert gases
Pressure range :	0 to 10 bar
Regulating range :	0 to 8 bar
Lubrication :	Not required, if used select a medium aniline point lubricant (between 80°C and 100°C)
Filtration :	40 μ
Temperature range :	-18°C to +50°C
Flow (at 6 bar, ΔP=1bar) :	1100 NI/min (Cv 1.1)

- Spare parts :
- Pressure regulator (less sandwich block): PRP1A-FOKA
 - Regulator block to base mounting tie rod: 19496

DIMENSIONS

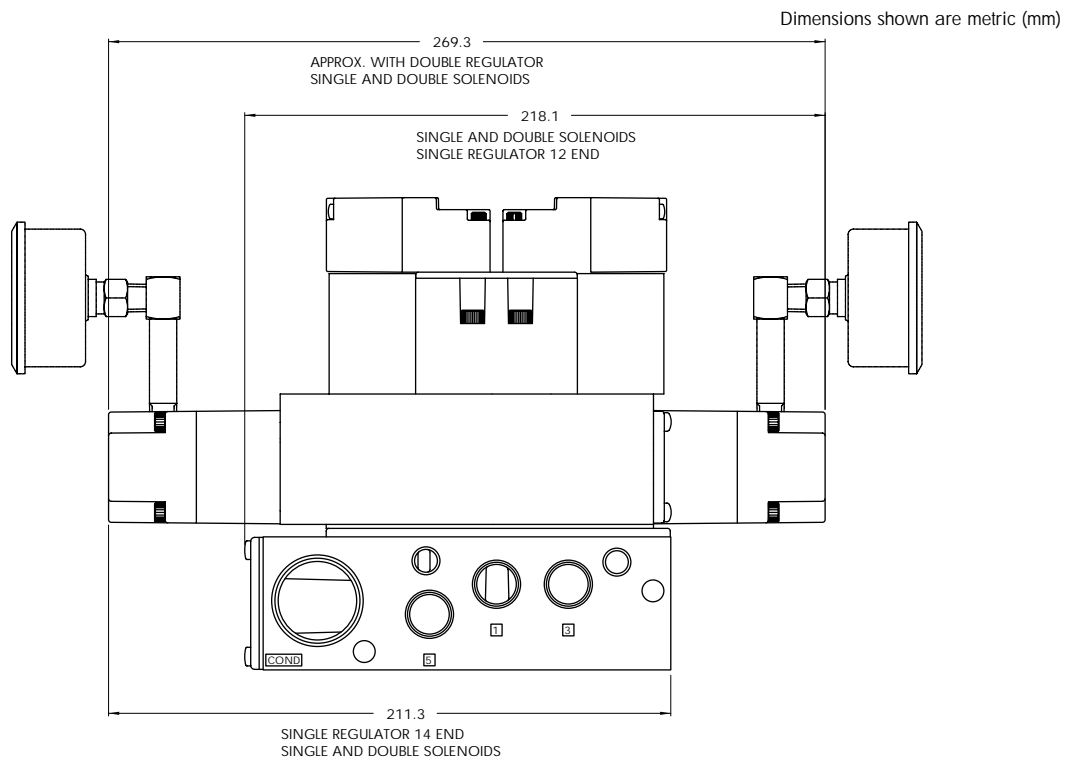

Non plug-in sandwich pressure regulator with manual adjust knob

OPERATIONAL BENEFITS

1. Easy mounting : saves on installation costs in comparison with inline regulators.
2. Allows to have compact, all-included units.
3. Large orifice provides high flow.
4. Various functions available.
5. Simple, reliable and solid design.



PR37A
PR42A
PR47A
PR48A
PR92C

HOW TO ORDER

INTERNAL PILOT

Gauge	Single pressure Regulator 14 end Same regulated pressure to ports 2 and 4	Single pressure Regulator 12 end Same regulated pressure to ports 2 and 4	Dual pressure Regulator 14 end Regulated pressure to port 4 *	Dual pressure Regulator 12 end Regulated pressure to port 2 *	Dual pressure Dual regulator Two regulated pressures to ports 2 and 4 *
No gauge	PRA2D-1AAA	PRA2D-1EAA	PRA2D-1BAA	PRA2D-1FAA	PRA2D-1JAA
Non-filled gauge on regulator(s)	PRA2D-1ADA	PRA2D-1EDA	PRA2D-1BDA	PRA2D-1FDA	PRA2D-1JEA
Non-filled gauge opposite to regulator	PRA2D-1CDA	PRA2D-1GDA	PRA2D-1DDA	PRA2D-1HDA	-----
Glycerine filled gauge on regulator(s)	PRA2D-1ABA	PRA2D-1EBA	PRA2D-1BBA	PRA2D-1FBA	PRA2D-1JCA
Glycerine filled gauge opposite to regulator	PRA2D-1CBA	PRA2D-1GBA	PRA2D-1DBA	PRA2D-1HBA	-----

PR93A
PRA1A

EXTERNAL PILOT AND REMOTE AIR

Gauge	Single pressure Regulator 14 end Same regulated pressure to ports 2 and 4	Single pressure Regulator 12 end Same regulated pressure to ports 2 and 4	Dual pressure Regulator 14 end Regulated pressure to port 4 *	Dual pressure Regulator 12 end Regulated pressure to port 2 *	Dual pressure Dual regulator Two regulated pressures to ports 2 and 4 *
No gauge	PRA2D-2AAA	PRA2D-2EAA	PRA2D-2BAA	PRA2D-2FAA	PRA2D-2JAA
Non-filled gauge on regulator(s)	PRA2D-2ADA	PRA2D-2EDA	PRA2D-2BDA	PRA2D-2FDA	PRA2D-2JEA
Non-filled gauge opposite to regulator	PRA2D-2CDA	PRA2D-2GDA	PRA2D-2DDA	PRA2D-2HDA	-----
Glycerine filled gauge on regulator(s)	PRA2D-2ABA	PRA2D-2EBA	PRA2D-2BBA	PRA2D-2FBA	PRA2D-2JCA
Glycerine filled gauge opposite to regulator	PRA2D-2CBA	PRA2D-2GBA	PRA2D-2DBA	PRA2D-2HBA	-----

PRP1A
PRA2D

* - To be used with dual pressure valves.
Note : regulating range for above models is 0-10 bar.
For other ranges see technical data page.

Main valve body assembly must be external pilot model. Pilots are supplied internally from primary pressure in regulator block. Cannot field convert regulator block from Single Pressure to dual pressure. Body/Block to base mounting screw #19177.

ADJUSTMENT OPTIONS

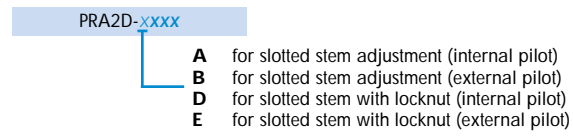

PRP2B
PRA3C
PRP3B

TECHNICAL DATA

Fluid :	Compressed air, inert gases
Pressure range :	0 to 10 bar
Regulating range :	0 to 10 bar (other ranges see below)
Lubrication :	Not required, if used select a medium aniline point lubricant (between 80°C to 100°C)
Filtration :	40 μ
Temperature range :	-18°C to 50°C
Flow :	2300 NI/min (Cv 2.3)

- Spare parts :
- Pressure regulator (less sandwich block) : PRA2D-30AA (KNOB), PRA2D-C0AA (SLOTTED STEM), PRA2D-F0AA (SLOTTED STEM WITH LOCKNUT).
 - Gauge : • Glycerine filled : N-62015-01
 - Non filled : N-62016-01

Regulating range options : PRA2D-XXXX

- Replace by B - 0 to 6,7 bar
- Replace by C - 0 to 3 bar

DIMENSIONS

Dimensions shown are metric (mm)

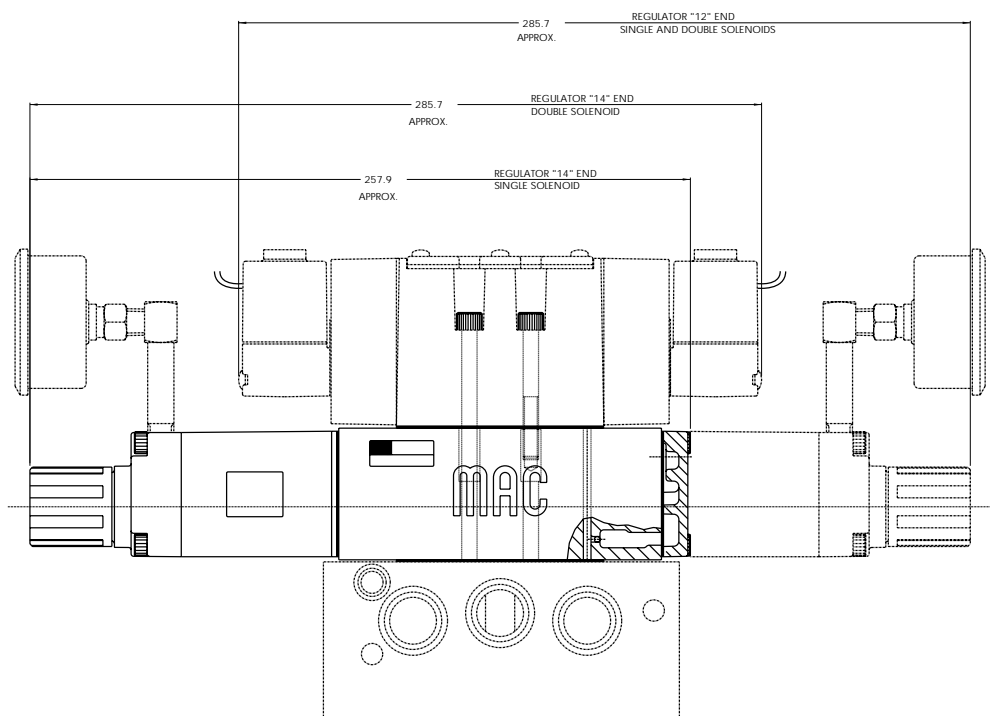

Non plug-in sandwich pressure regulator with air pilot adjust

OPERATIONAL BENEFITS

1. Easy mounting : saves on installation costs in comparison with inline regulators.
2. Allows to have compact, all-included units.
3. Large orifice provides high flow.
4. Various functions available.
5. Simple, reliable and solid design.

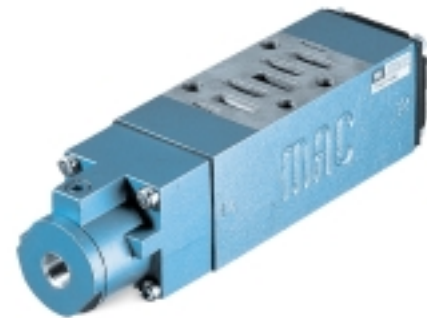

PR37A
PR42A
PR47A
PR48A
PR92C

HOW TO ORDER

INTERNAL PILOT

Gauge	Single pressure Regulator 14 end Same regulated pressure to ports 2 and 4	Single pressure Regulator 12 end Same regulated pressure to ports 2 and 4	Dual pressure Regulator 14 end Regulated pressure to port 4 *	Dual pressure Regulator 12 end Regulated pressure to port 2 *	Dual pressure Dual regulator Two regulated pressures to ports 2 and 4 *
No gauge	PRA2D-4AAA	PRA2D-4EAA	PRA2D-4BAA	PRA2D-4FAA	PRA2D-4JAA
Non-filled gauge on regulator(s)	PRA2D-4ADA	PRA2D-4EDA	PRA2D-4BDA	PRA2D-4FDA	PRA2D-4JEA
Non-filled gauge opposite to regulator	PRA2D-4CDA	PRA2D-4GDA	PRA2D-4DDA	PRA2D-4HDA	-----
Glycerine filled gauge on regulator(s)	PRA2D-4ABA	PRA2D-4EBA	PRA2D-4BBA	PRA2D-4FBA	PRA2D-4JCA
Glycerine filled gauge opposite to regulator	PRA2D-4CBA	PRA2D-4GBA	PRA2D-4DBA	PRA2D-4HBA	-----

PR93A
PRA1A

EXTERNAL PILOT AND REMOTE AIR

Gauge	Single pressure Regulator 14 end Same regulated pressure to ports 2 and 4	Single pressure Regulator 12 end Same regulated pressure to ports 2 and 4	Dual pressure Regulator 14 end Regulated pressure to port 4 *	Dual pressure Regulator 12 end Regulated pressure to port 2 *	Dual pressure Dual regulator Two regulated pressures to ports 2 and 4 *
No gauge	PRA2D-5AAA	PRA2D-5EAA	PRA2D-5BAA	PRA2D-5FAA	PRA2D-5JAA
Non-filled gauge on regulator(s)	PRA2D-5ADA	PRA2D-5EDA	PRA2D-5BDA	PRA2D-5FDA	PRA2D-5JEA
Non-filled gauge opposite to regulator	PRA2D-5CDA	PRA2D-5GDA	PRA2D-5DDA	PRA2D-5HDA	-----
Glycerine filled gauge on regulator(s)	PRA2D-5ABA	PRA2D-5EBA	PRA2D-5BBA	PRA2D-5FBA	PRA2D-5JCA
Glycerine filled gauge opposite to regulator	PRA2D-5CBA	PRA2D-5GBA	PRA2D-5DBA	PRA2D-5HBA	-----

PRP1A
PRA2D

PRP2B
PRA3C

* - To be used with dual pressure valves.

Main valve body assembly must be external pilot model. Pilots are supplied internally from primary pressure in regulator block. Cannot field convert regulator block from Single Pressure to dual pressure. Body/Block to base mounting screw #19177.

PRP3B

TECHNICAL DATA

Fluid :	Compressed air, inert gases
Pressure range :	0 to 10 bar
Regulating range :	0 to 10 bar
Lubrication :	Not required, if used select a medium aniline point lubricant (between 80°C to 100°C)
Filtration :	40 μ
Temperature range :	-18°C to 50°C
Flow :	2300 NI/min (Cv 2.3)

- Spare parts :
- Pressure regulator (less sandwich block) : PRA2D-60AA.
 - Gauge : • Glycerine filled : N-62015-01
 - Non filled : N-62016-01

DIMENSIONS

Dimensions shown are metric (mm)

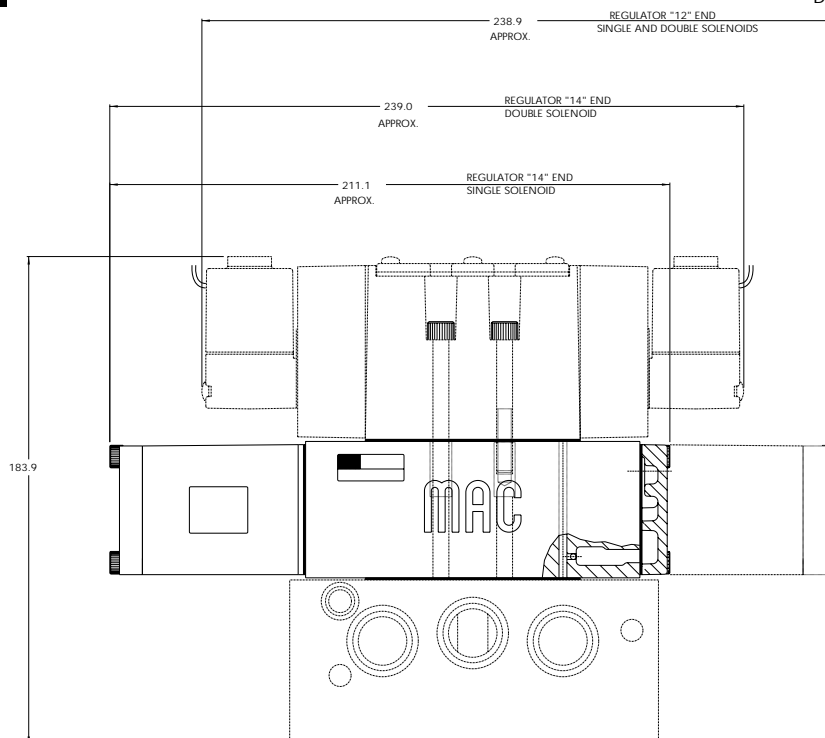

Plug-in sandwich pressure regulator with manual adjust knob

OPERATIONAL BENEFITS

1. Easy mounting: saves on installation costs in comparison with inline regulators.
2. Compact all-included units.
3. Large orifice provides high flow.
4. Various functions available.
5. Simple, reliable and solid design.



PR37A
PR42A
PR47A
PR48A
PR92C

HOW TO ORDER

REGULATORS FOR INTERNAL PILOT (CODED FOR KNOB ADJUSTMENT)

Gauge	Single pressure Regulator 14 end Same regulated pressure to ports 2 and 4	Single pressure Regulator 12 end Same regulated pressure to ports 2 and 4	Dual pressure Regulator 14 end Regulated pressure to port 4 *	Dual pressure Regulator 12 end Regulated pressure to port 2 *	Dual pressure Regulator 12 end Two regulated pressures to ports 2 and 4 *
No gauge	PRP2B-AAAA	PRP2B-AEAA	PRP2B-ABAA	PRP2B-AFAA	PRP2B-AJAA
Glycerine gauge	PRP2B-AABA	PRP2B-AEBA	PRP2B-ABBA	PRP2B-AFBA	PRP2B-AJCA
Non-filled gauge	PRP2B-AADA	PRP2B-AEDA	PRP2B-ABDA	PRP2B-AFDA	PRP2B-AJEA

PR93A
PRA1A

REGULATORS FOR EXTERNAL PILOT AND REMOTE AIR (CODED FOR KNOB ADJUSTMENT)

Gauge	Single pressure Regulator 14 end Same regulated pressure to ports 2 and 4	Single pressure Regulator 12 end Same regulated pressure to ports 2 and 4	Dual pressure Regulator 14 end Regulated pressure to port 4 *	Dual pressure Regulator 12 end Regulated pressure to port 2 *	Dual pressure Regulator 12 end Two regulated pressures to ports 2 and 4 *
No gauge	PRP2B-BAAA	PRP2B-BEAA	PRP2B-BBAA	PRP2B-BFAA	PRP2B-BJAA
Glycerine gauge	PRP2B-BABA	PRP2B-BEBA	PRP2B-BBBA	PRP2B-BFBA	PRP2B-BJCA
Non-filled gauge	PRP2B-BADA	PRP2B-BEDA	PRP2B-BBDA	PRP2B-BFDA	PRP2B-BJEA

PRP1A
PRA2D
PRP2B

* For use with dual pressure valves.

Note: Regulating range for above models is 0-10 bar. For other ranges, see technical data page.

ADJUSTMENT OPTIONS

PRP1A-xxxx

- G for slotted stem (internal pilot)
- H for slotted stem (external pilot)
- K for slotted stem with locknut (internal pilot)
- L for slotted stem with locknut (external pilot)

Notes:

1. Valves used with above models must be external pilot models.
2. Cannot field convert regulator block from single pressure to dual pressure.
3. Cannot field convert from internal pilot to external pilot.
4. Wired for double solenoid valves.

Consult "Precautions" before use, installation or service of MAC Valves..

PRA3C
PRP3B

TECHNICAL DATA

Fluid :	Compressed air, inert gases
Pressure range :	0 to 10 bar
Regulating range :	0 to 10 bar
Lubrication :	Not required, if used select a medium aniline point lubricant (between 80°C and 100°C)
Filtration :	40 μ
Temperature range :	-18°C to +50°C
Flow (at 6 bar, ΔP=1bar)	3100 NI/min (Cv 3.1)

Spare parts :

- Pressure regulator (less sandwich block) PRP2B-COAA (knob), PRP2B-JOAA (slotted stem), PRP2B-MOAA (slotted stem with locknut)
- Regulator block to base mounting screw: 19177
- Regulating range option: PRP2B-xxxA
 - Replace by B for 0 to 6,7 bar
 - Replace by C for 0 to 3 bar

DIMENSIONS

Dimensions shown are metric (mm)

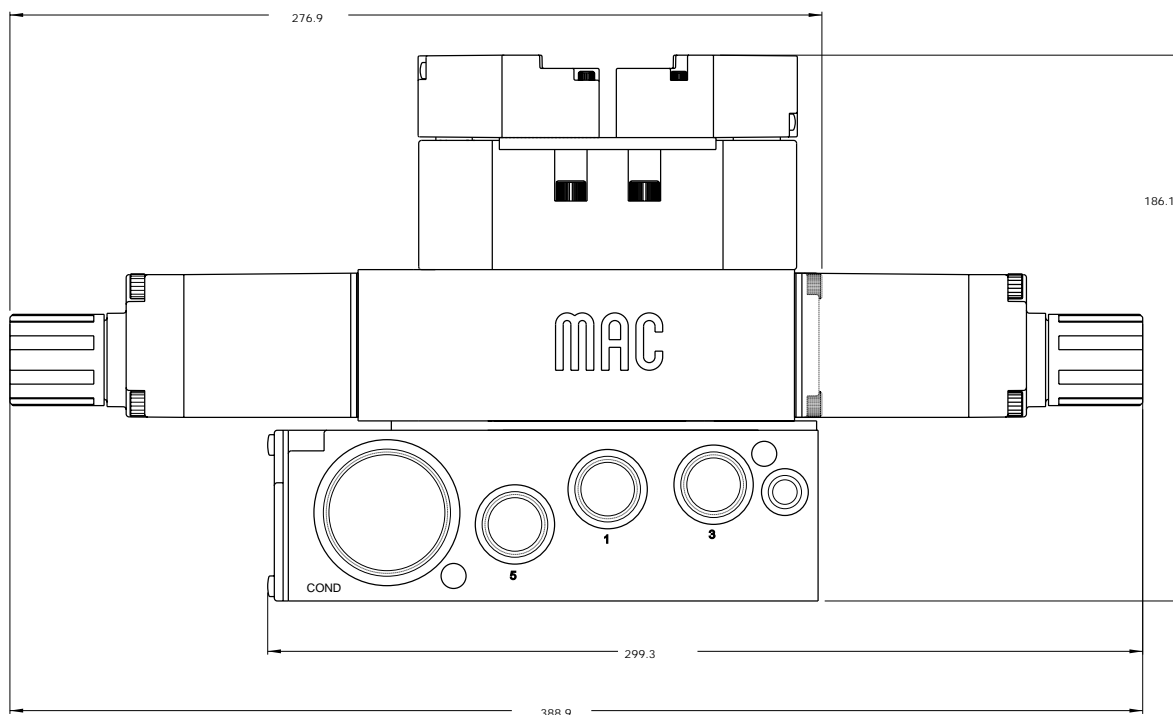

Plug-in sandwich pressure regulator with air pilot adjust

OPERATIONAL BENEFITS

1. Easy mounting: saves on installation costs in comparison with inline regulators.
2. Compact all-included units.
3. Large orifice provides high flow.
4. Various functions available.
5. Simple, reliable and solid design.



PR37A

PR42A

PR47A

PR48A

PR92C

HOW TO ORDER

REGULATORS FOR INTERNAL PILOT

Gauge	Single pressure Regulator 14 end Same regulated pressure to ports 2 and 4	Single pressure Regulator 12 end Same regulated pressure to ports 2 and 4	Dual pressure Regulator 14 end Regulated pressure to port 4 *	Dual pressure Regulator 12 end Regulated pressure to port 2 *	Dual pressure Dual regulator Two regulated pressures to ports 2 and 4 *
No gauge	PRP2B-DAAA	PRP2B-DEAA	PRP2B-DBAA	PRP2B-DFAA	PRP2B-DJAA
Glycerine gauge	PRP2B-DABA	PRP2B-DEBA	PRP2B-DBBA	PRP2B-DFBA	PRP2B-DJCA
Non-filled gauge	PRP2B-DADA	PRP2B-DEDA	PRP2B-DBDA	PRP2B-DFDA	PRP2B-DJEA

PR93A

PRA1A

REGULATORS FOR EXTERNAL PILOT AND REMOTE AIR

Gauge	Single pressure Regulator 14 end Same regulated pressure to ports 2 and 4	Single pressure Regulator 12 end Same regulated pressure to ports 2 and 4	Dual pressure Regulator 14 end Regulated pressure to port 4 *	Dual pressure Regulator 12 end Regulated pressure to port 2 *	Dual pressure Dual regulator Two regulated pressures to ports 2 and 4 *
No gauge	PRP2B-EAAA	PRP2B-EEAA	PRP2B-EBAA	PRP2B-EFAA	PRP2B-EJAA
Glycerine gauge	PRP2B-EABA	PRP2B-EEBA	PRP2B-EBBA	PRP2B-EFBA	PRP2B-EJCA
Non-filled gauge	PRP2B-EADA	PRP2B-EEDA	PRP2B-EBDA	PRP2B-EFDA	PRP2B-EJEA

PRP1A

PRA2D

PRP2B

* - To be used with dual pressure valves.

Notes:

1. Valves used with above models must be external pilot models.
2. Cannot field convert regulator block from single pressure to dual pressure.
3. Cannot field convert from internal pilot to external pilot.
4. Wired for double solenoid valves.

PRA3C

PRP3B

TECHNICAL DATA

Fluid :	Compressed air, inert gases
Pressure range :	0 to 10 bar
Regulating range :	0 to 10 bar
Lubrication :	Not required, if used select a medium aniline point lubricant (between 80°C and 100°C)
Filtration :	40 µ
Temperature range :	-18°C to +50°C
Flow (at 6 bar, ΔP=1bar) :	3100 NI/min (Cv 3.1)

- Spare parts :
- Pressure regulator (less sandwich block): PRP2B-F0AA
 - Body/block to base mounting screw: 19177

DIMENSIONS

Dimensions shown are metric (mm)

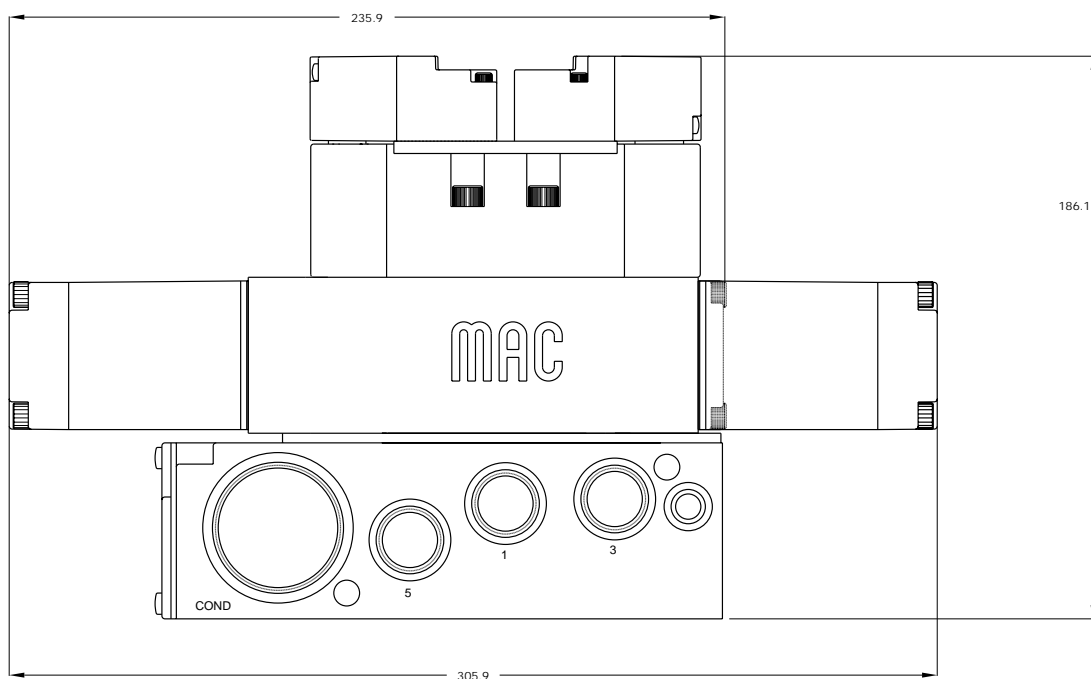

Non plug-in sandwich pressure regulator with manual adjust knob

OPERATIONAL BENEFITS

1. Easy mounting : saves on installation costs in comparison with inline regulators.
2. Allows to have compact, all-included units.
3. Large orifice provides high flow.
4. Various functions available.
5. Simple, reliable and solid design.



PR37A
PR42A
PR47A
PR48A

PR92C

HOW TO ORDER

INTERNAL PILOT

Gauge	Single pressure Regulator 14 end Same regulated pressure to ports 2 and 4	Single pressure Regulator 12 end Same regulated pressure to ports 2 and 4	Dual pressure Regulator 14 end Regulated pressure to port 4 *	Dual pressure Regulator 12 end Regulated pressure to port 2 *	Dual pressure Dual regulator Two regulated pressures to ports 2 and 4 *
No gauge	PRA3C-1AAA	PRA3C-1EAA	PRA3C-1BAA	PRA3C-1FAA	PRA3C-1JAA
Non-filled gauge on regulator(s)	PRA3C-1ADA	PRA3C-1EDA	PRA3C-1BDA	PRA3C-1FDA	PRA3C-1JEA
Non-filled gauge opposite to regulator	PRA3C-1CDA	PRA3C-1GDA	PRA3C-1DDA	PRA3C-1HDA	-----
Glycerine filled gauge on regulator(s)	PRA3C-1ABA	PRA3C-1EBA	PRA3C-1BBA	PRA3C-1FBA	PRA3C-1JCA
Glycerine filled gauge opposite to regulator	PRA3C-1CBA	PRA3C-1GBA	PRA3C-1DBA	PRA3C-1HBA	-----

PR93A

PRA1A

EXTERNAL PILOT AND REMOTE AIR

Gauge	Single pressure Regulator 14 end Same regulated pressure to ports 2 and 4	Single pressure Regulator 12 end Same regulated pressure to ports 2 and 4	Dual pressure Regulator 14 end Regulated pressure to port 4 *	Dual pressure Regulator 12 end Regulated pressure to port 2 *	Dual pressure Dual regulator Two regulated pressures to ports 2 and 4 *
No gauge	PRA3C-2AAA	PRA3C-2EAA	PRA3C-2BAA	PRA3C-2FAA	PRA3C-2JAA
Non-filled gauge on regulator(s)	PRA3C-2ADA	PRA3C-2EDA	PRA3C-2BDA	PRA3C-2FDA	PRA3C-2JEA
Non-filled gauge opposite to regulator	PRA3C-2CDA	PRA3C-2GDA	PRA3C-2DDA	PRA3C-2HDA	-----
Glycerine filled gauge on regulator(s)	PRA3C-2ABA	PRA3C-2EBA	PRA3C-2BBA	PRA3C-2FBA	PRA3C-2JCA
Glycerine filled gauge opposite to regulator	PRA3C-2CBA	PRA3C-2GBA	PRA3C-2DBA	PRA3C-2HBA	-----

PRP1A

PRA2D

PRP2B

* - To be used with dual pressure valves.
Note : regulating range for above models is 0-10 bar.
For other ranges see technical data page.

Main valve body assembly must be external pilot model. Pilots are supplied internally from primary pressure in regulator block. Cannot field convert regulator block from Single Pressure to dual pressure. Body/Block to base mounting screw #35418.

ADJUSTMENT OPTIONS

PRA3C-xxxx

- A** for slotted stem adjustment (internal pilot)
- B** for slotted stem adjustment (external pilot)
- D** for slotted stem with locknut (internal pilot)
- E** for slotted stem with locknut (external pilot)

PRA3C

PRP3B

TECHNICAL DATA

Fluid :	Compressed air, inert gases
Pressure range :	0 to 10 bar
Regulating range :	0 to 10 bar (other ranges see below)
Lubrication :	Not required, if used select a medium aniline point lubricant (between 80°C to 100°C)
Filtration :	40 μ
Temperature range :	-18°C to 50°C
Flow :	5400 NI/min (Cv 5.4)

- Spare parts :
- Pressure regulator (less sandwich block) : PRA3C-30AA (KNOB), PRA3C-C0AA (SLOTTED STEM), PRA3C-F0AA (SLOTTED STEM WITH LOCKNUT).
 - Gauge : • Glycerine filled : N-62015-01
• Non filled : N-62016-01

Regulating range options : PRA3C-XXXX

- Replace by B - 0 to 6,7 bar
- Replace by C - 0 to 3 bar

DIMENSIONS

Dimensions shown are metric (mm)

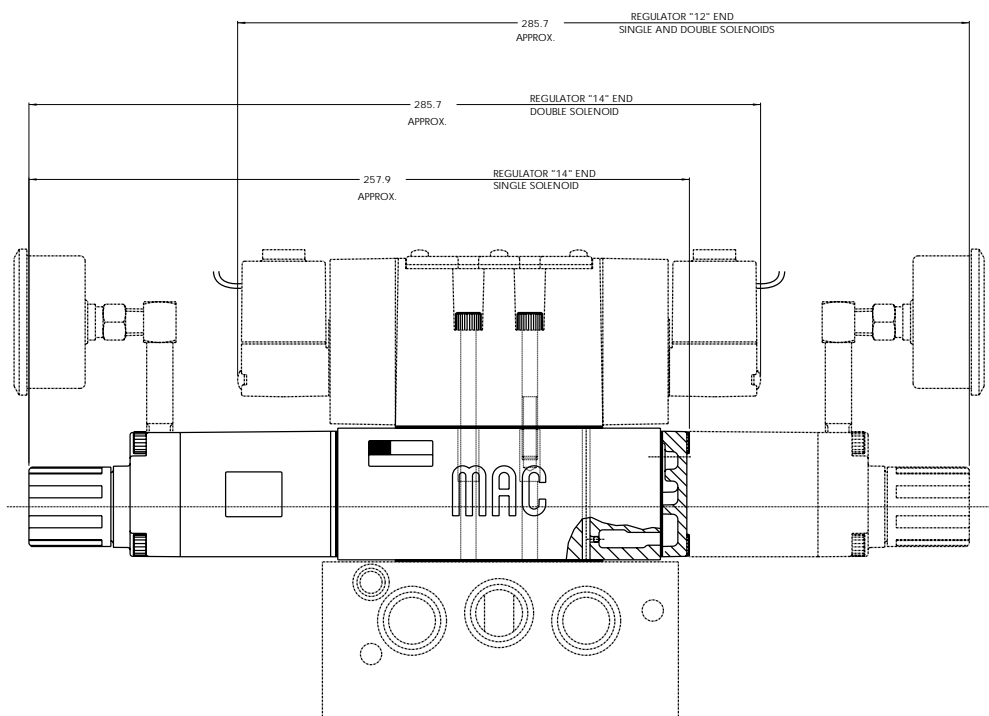

Non plug-in sandwich pressure regulator with air pilot adjust

OPERATIONAL BENEFITS

1. Easy mounting : saves on installation costs in comparison with inline regulators.
2. Allows to have compact, all-included units.
3. Large orifice provides high flow.
4. Various functions available.
5. Simple, reliable and solid design.



PR37A
PR42A
PR47A
PR48A

PR92C

HOW TO ORDER

INTERNAL PILOT

Gauge	Single pressure Regulator 14 end Same regulated pressure to ports 2 and 4	Single pressure Regulator 12 end Same regulated pressure to ports 2 and 4	Dual pressure Regulator 14 end Regulated pressure to port 4 *	Dual pressure Regulator 12 end Regulated pressure to port 2 *	Dual pressure Dual regulator Two regulated pressures to ports 2 and 4 *
No gauge	PRA3C-4AAA	PRA3C-4EAA	PRA3C-4BAA	PRA3C-4FAA	PRA3C-4JAA
Non-filled gauge on regulator(s)	PRA3C-4ADA	PRA3C-4EDA	PRA3C-4BDA	PRA3C-4FDA	PRA3C-4JEA
Non-filled gauge opposite to regulator	PRA3C-4CDA	PRA3C-4GDA	PRA3C-4DDA	PRA3C-4HDA	-----
Glycerine filled gauge on regulator(s)	PRA3C-4ABA	PRA3C-4EBA	PRA3C-4BBA	PRA3C-4FBA	PRA3C-4JCA
Glycerine filled gauge opposite to regulator	PRA3C-4CBA	PRA3C-4GBA	PRA3C-4DBA	PRA3C-4HBA	-----

PR93A

PRA1A

EXTERNAL PILOT AND REMOTE AIR

Gauge	Single pressure Regulator 14 end Same regulated pressure to ports 2 and 4	Single pressure Regulator 12 end Same regulated pressure to ports 2 and 4	Dual pressure Regulator 14 end Regulated pressure to port 4 *	Dual pressure Regulator 12 end Regulated pressure to port 2 *	Dual pressure Dual regulator Two regulated pressures to ports 2 and 4 *
No gauge	PRA3C-5AAA	PRA3C-5EAA	PRA3C-5BAA	PRA3C-5FAA	PRA3C-5JAA
Non-filled gauge on regulator(s)	PRA3C-5ADA	PRA3C-5EDA	PRA3C-5BDA	PRA3C-5FDA	PRA3C-5JEA
Non-filled gauge opposite to regulator	PRA3C-5CDA	PRA3C-5GDA	PRA3C-5DDA	PRA3C-5HDA	-----
Glycerine filled gauge on regulator(s)	PRA3C-5ABA	PRA3C-5EBA	PRA3C-5BBA	PRA3C-5FBA	PRA3C-5JCA
Glycerine filled gauge opposite to regulator	PRA3C-5CBA	PRA3C-5GBA	PRA3C-5DBA	PRA3C-5HBA	-----

PRP1A

PRA2D

PRP2B

* - To be used with dual pressure valves.

Main valve body assembly must be external pilot model. Pilots are supplied internally from primary pressure in regulator block. Cannot field convert regulator block from Single Pressure to dual pressure. Body/Block to base mounting screw #35418.

PRA3C

PRP3B

TECHNICAL DATA

Fluid :	Compressed air, inert gases
Pressure range :	0 to 10 bar
Regulating range :	0 to 10 bar
Lubrication :	Not required, if used select a medium aniline point lubricant (between 80°C to 100°C)
Filtration :	40 μ
Temperature range :	-18°C to 50°C
Flow :	5400 NI/min (Cv 5.4)

- Spare parts :
- Pressure regulator (less sandwich block) : PRA3C-60AA.
 - Gauge : • Glycerine filled : N-62015-01
 - Non filled : N-62016-01

DIMENSIONS

Dimensions shown are metric (mm)

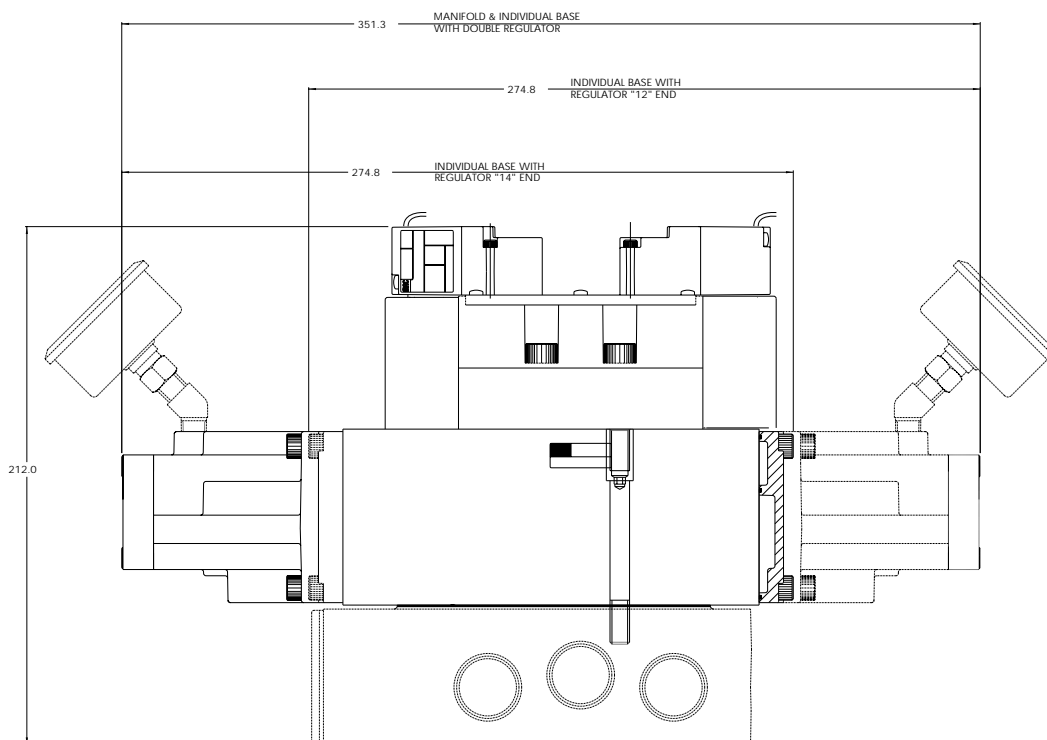

Plug-in sandwich pressure regulator with manual adjust knob

OPERATIONAL BENEFITS

1. Easy mounting: saves on installation costs in comparison with inline regulators.
2. Compact all-included units.
3. Large orifice provides high flow.
4. Various functions available.
5. Simple, reliable and solid design.



PR37A
PR42A
PR47A
PR48A
PR92C

HOW TO ORDER

REGULATORS FOR INTERNAL PILOT (CODED FOR KNOB ADJUSTMENT)

Gauge	Single pressure Regulator 14 end Same regulated pressure to ports 2 and 4	Single pressure Regulator 12 end Same regulated pressure to ports 2 and 4	Dual pressure Regulator 14 end Regulated pressure to port 4 *	Dual pressure Regulator 12 end Regulated pressure to port 2 *	Dual pressure Regulator Dual regulator Two regulated pressures to ports 2 and 4 *
No gauge	PRP3B-AAAA	PRP3B-AEAA	PRP3B-ABAA	PRP3B-AFAA	PRP3B-AJAA
Glycerine gauge	PRP3B-AABA	PRP3B-AEBA	PRP3B-ABBA	PRP3B-AFBA	PRP3B-AJCA
Non-filled gauge	PRP3B-AADA	PRP3B-AEDA	PRP3B-ABDA	PRP3B-AFDA	PRP3B-AJEA

PR93A
PRA1A

REGULATORS FOR EXTERNAL PILOT AND REMOTE AIR (CODED FOR KNOB ADJUSTMENT)

Gauge	Single pressure Regulator 14 end Same regulated pressure to ports 2 and 4	Single pressure Regulator 12 end Same regulated pressure to ports 2 and 4	Dual pressure Regulator 14 end Regulated pressure to port 4 *	Dual pressure Regulator 12 end Regulated pressure to port 2 *	Dual pressure Regulator Dual regulator Two regulated pressures to ports 2 and 4 *
No gauge	PRP3B-BAAA	PRP3B-BEAA	PRP3B-BBAA	PRP3B-BFAA	PRP3B-BJAA
Glycerine gauge	PRP3B-BABA	PRP3B-BEBA	PRP3B-BBBA	PRP3B-BFBA	PRP3B-BJCA
Non-filled gauge	PRP3B-BADA	PRP3B-BEDA	PRP3B-BBDA	PRP3B-BFDA	PRP3B-BJEA

PRP1A
PRA2D
PRP2B

* For use with dual pressure valves.

ADJUSTMENT OPTIONS

PRP3B-xxxx

- G** for slotted stem (internal pilot)
- H** for slotted stem (external pilot)
- K** for slotted stem with locknut (internal pilot)
- L** for slotted stem with locknut (external pilot)

Notes:

1. Regulating range for above models is 0-10 bar. For other ranges, see technical data page.
2. Valves used with above models must be external pilot models.
3. Cannot field convert regulator block from single pressure to dual pressure.
4. Cannot field convert from internal pilot to external pilot.
5. Wired for double solenoid valves.

PRA3C

PRP3B

TECHNICAL DATA

Fluid :	Compressed air, inert gases
Pressure range :	0 to 10 bar
Regulating range :	0 to 10 bar
Lubrication :	Not required, if used select a medium aniline point lubricant (between 80°C and 100°C)
Filtration :	40 μ
Temperature range :	-18°C to +50°C
Flow (at 6 bar, ΔP=1bar)	5400 NI/min (Cv 5.4)

- Spare parts :
- Pressure regulator (less sandwich block): PRP3B-COAA (knob), PRP3B-JOAA (slotted stem), PRP3B-MOAA (slotted stem with locknut)
 - Regulating block to base mounting screw: 19457
 - Regulating range options: PRP3B-xxxA

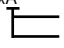
 Replace by B for 0 to 6,7 bar
 Replace by C for 0 to 3 bar

DIMENSIONS

Dimensions shown are metric (mm)

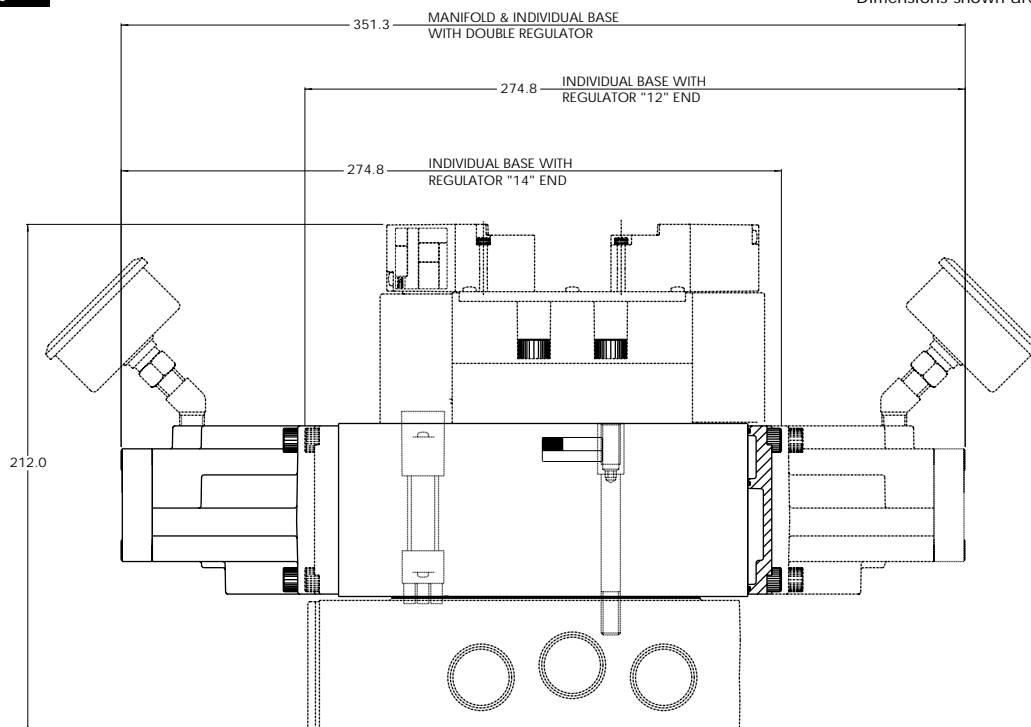

Plug-in sandwich pressure regulator with air pilot adjust

OPERATIONAL BENEFITS

1. Easy mounting: saves on installation costs in comparison with inline regulators.
2. Compact all-included units.
3. Large orifice provides high flow.
4. Various functions available.
5. Simple, reliable and solid design.



PR37A
PR42A
PR47A
PR48A
PR92C

HOW TO ORDER

REGULATORS FOR INTERNAL PILOT

Gauge	Single pressure Regulator 14 end Same regulated pressure to ports 2 and 4	Single pressure Regulator 12 end Same regulated pressure to ports 2 and 4	Dual pressure Regulator 14 end Regulated pressure to port 4 *	Dual pressure Regulator 12 end Regulated pressure to port 2 *	Dual pressure Dual regulator Two regulated pressures to ports 2 and 4 *
No gauge	PRP3B-DAAA	PRP3B-DEAA	PRP3B-DBAA	PRP3B-DFAA	PRP3B-DJAA
Glycerine gauge	PRP3B-DABA	PRP3B-DEBA	PRP3B-DBBA	PRP3B-DFBA	PRP3B-DJCA
Non-filled gauge	PRP3B-DADA	PRP3B-DEDA	PRP3B-DBDA	PRP3B-DFDA	PRP3B-DJEA

PR93A
PRA1A

REGULATORS FOR EXTERNAL PILOT AND REMOTE AIR

Gauge	Single pressure Regulator 14 end Same regulated pressure to ports 2 and 4	Single pressure Regulator 12 end Same regulated pressure to ports 2 and 4	Dual pressure Regulator 14 end Regulated pressure to port 4 *	Dual pressure Regulator 12 end Regulated pressure to port 2 *	Dual pressure Dual regulator Two regulated pressures to ports 2 and 4 *
No gauge	PRP3B-EAAA	PRP3B-EEAA	PRP3B-EBAA	PRP3B-EFAA	PRP3B-EJAA
Glycerine gauge	PRP3B-EABA	PRP3B-EEBA	PRP3B-EBBA	PRP3B-EFBA	PRP3B-EJCA
Non-filled gauge	PRP3B-EADA	PRP3B-EEDA	PRP3B-EBDA	PRP3B-EFDA	PRP3B-EJEA

PRP1A
PRA2D
PRP2B

* - To be used with dual pressure valves.

Notes:

1. Valves used with above models must be external pilot models.
2. Cannot field convert regulator block from single pressure to dual pressure.
3. Cannot field convert from internal pilot to external pilot.
4. Wired for double solenoid valves.

PRA3C

PRP3B

TECHNICAL DATA

Fluid :	Compressed air, inert gases
Pressure range :	0 to 10 bar
Regulating range :	0 to 10 bar
Lubrication :	Not required, if used select a medium aniline point lubricant (between 80°C and 100°C)
Filtration :	40 µ
Temperature range :	-18°C to +50°C
Flow (at 6 bar, ΔP=1bar) :	5400 NI/min (Cv 5.4)

- Spare parts :
- Pressure regulator (less sandwich block): PRP3B-FOAA
 - Regulator block to base mounting screw: 19457

DIMENSIONS

Dimensions shown are metric (mm)

