

Bimba EF Cylinders

The Bimba EF Series is a compact, aluminum-extruded body air cylinder designed for international machine requirements.

The body is anodized in a special PTFE-impregnation process that provides superior wear characteristics. With its streamlined look, low cost and low-profile switch, it is an excellent choice for space-saving machine design.

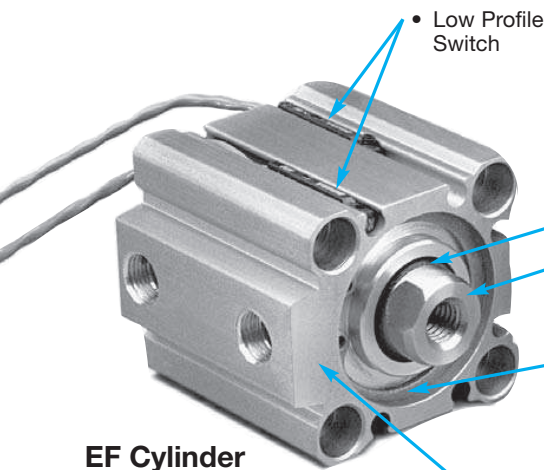

- Low Profile Switch
- Nitrile Piston Seal
- High Strength Aluminum Alloy Piston
- Nitrile Rod Seal and Wiper
- 4301 (303) Stainless Steel Rod
- Nitrile Rod Guide Seal
- Zinc Plated Carbon Steel Retaining Ring
- Bronze Bushing (12-20mm); Self-lubricating Nylon (25-100mm)
- Bronze Rod Guide (12-20mm); Anodized Aluminum (25-100mm)
- PTFE-Impregnated, Hard Anodized Aluminum Body

EFT Cylinder

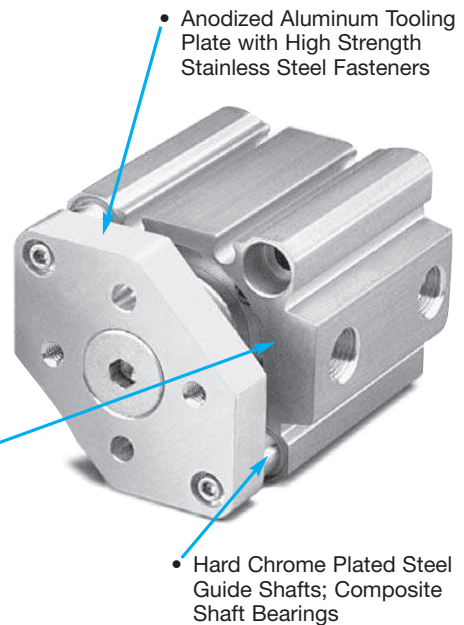

- Anodized Aluminum Tooling Plate with High Strength Stainless Steel Fasteners
- Hard Chrome Plated Steel Guide Shafts; Composite Shaft Bearings

FEATURES AND ADVANTAGES

- PTFE-impregnated, hard anodized aluminum body provides superior wear resistance. Expected service life is 2500 kilometers.
- Very compact; dimensionally-interchangeable with similar compact extruded aluminum body cylinders.
- Very low profile, compact switch slides into groove within cylinder geometry.
- EF1 cylinders are available in four models: double acting, single or double rod end; and single acting, spring return or extend, and EF2 cylinders are available in double acting, non-rotating.
- NEW!! EFDT cylinders are now available as a double acting, double ended, non-rotating rod cylinder to provide an additional operation feature from the cylinder rear.
- Both models are available in ten bore sizes from 12mm to 100mm.
- Wide variety of standard stroke lengths in 5mm increments; additional stroke lengths available.
- Standard cylinder is completely metric in design; with Option -E, threaded mounting options, rod threads and ports are in U.S. customary units (inch).
- Mounting options include threaded bottom mounting and threaded front/rear mounting option.
- Options include bumpers, ports and threaded mounting option and rod threads in U.S. customary units, magnetic position sensing, and high temperature seals.
- NEW!! X option for EFT and EFDT cylinders only. This option increases stability by at least two times and up to 23 times depending on bore size. In addition, the X option more than doubles the maximum cylinder side load and moment!

Bimba EF 1 Cylinders

How to Order

The Model Number for all EF1 cylinders consists of three alphanumeric clusters. These designate type, bore size and stroke length, and options. Please refer to the charts below for an example of Model Number EF-2510-3MMTV. This is a 25mm bore, double acting, single end rod cylinder, with metric threads and ports, 10mm of stroke, threaded front/rear mounting holes, magnetic position sensing, male rod end and high temperature option.

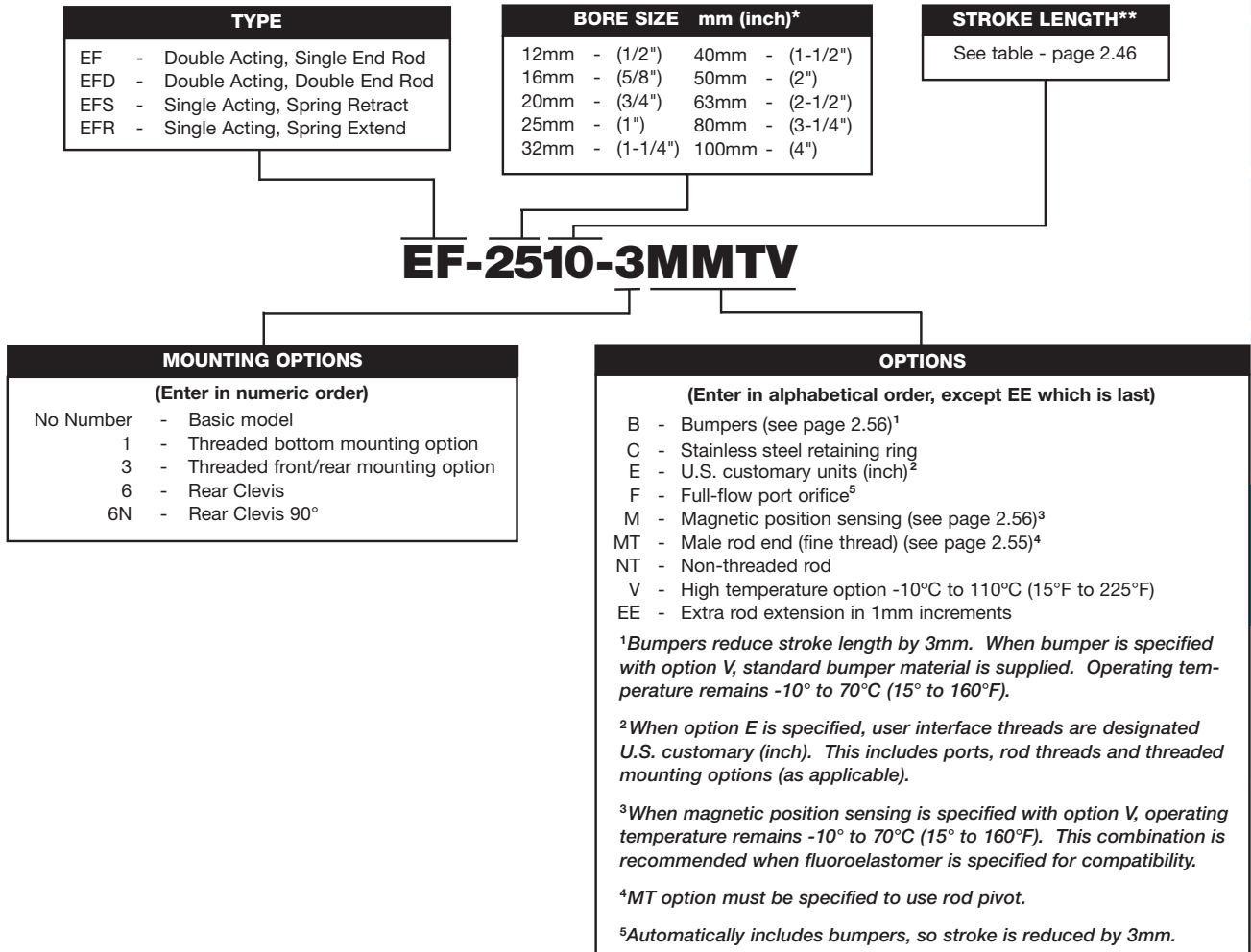

Please note that throughout all catalog charts, metric measurements are shown first and U.S. customary units (inches) are in parentheses.

*NOTE: Numbers in parentheses are the equivalent bore size in inches and listed FOR REFERENCE ONLY. DO NOT use for model designation.

**When stroke length exceeds 30mm, a threaded mounting option should be considered. Mounting bolts that span the entire cylinder length may not be readily available.

Flat-1/
Square Flat-1

Flat-II/
Square Flat-II

F02, F03, F04
(multiple power)

F0P
(multiple position)

Flat
Accessories

EF1/EE2

Stopper/
Twist Clamp

Extruded
Flat Lift Table

Twin Bore

NPA/
LPA

Diaphragm/
Miniature Cube